

**TFX Kreisförderer /
TFX Overhead Conveyor**

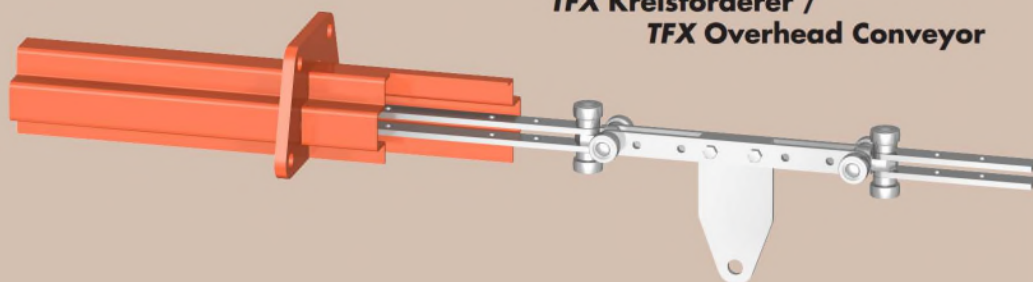

K8

50 kg/m

**TFX Kreisförderer /
TFX Overhead Conveyor**

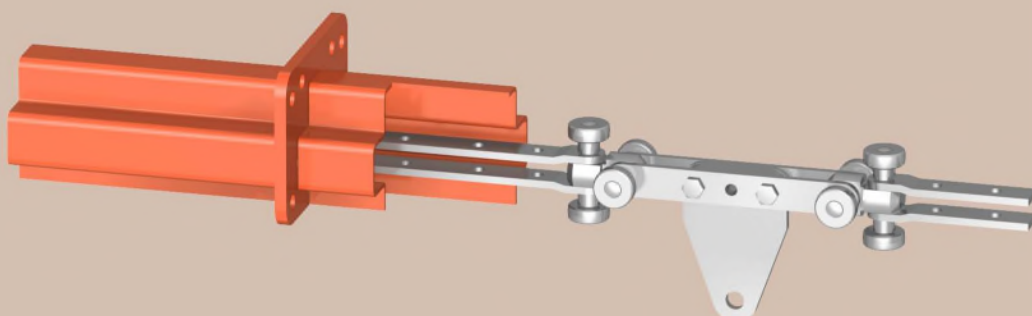

K10

100 kg/m

**TFX Power&Free-Förderer /
TFX Power&Free Conveyor**

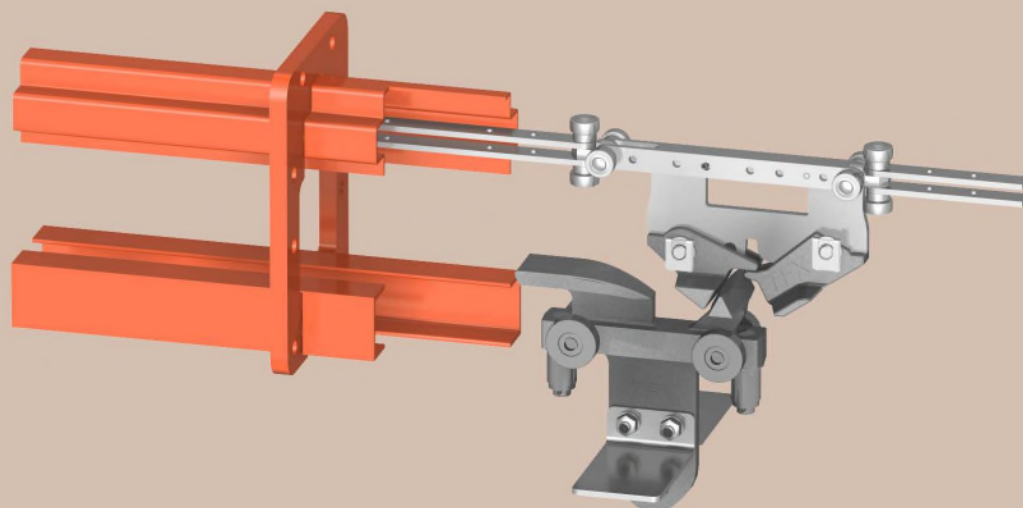

K8-2

120 kg/m

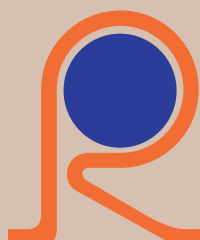

TFX RAILTECHNIK GmbH

SPEZIALISTEN FÜR FÖRDERSYSTEME

Kreisförderer / overhead conveyor K8

Gerade Laufschiene / straight tracks	3
Laufschiene-Bögen / Curve tracks	4
Förderketten / Conveyor chains	5
Hängerblech / hanger plate	8
Schleppketten-Antrieb / caterpillar drive unit	9
Kontroll-Montage-Schiene / control assembly rail	10
Spann-Station (Längenausgleich) / tension unit (length adjustment)	10
Schmier-Station / lubrication unit	11

Kreisförderer / overhead conveyor K10

Gerade Laufschiene / straight tracks	12
Laufschiene-Bögen / curve tracks	13
Förderketten / conveyor chains	14
Hängerblech / hanger plate	15
Schleppketten-Antrieb / caterpillar drive unit	16
Kontroll-Montage-Schiene / control assembly rail	17
Spann-Station (Längenausgleich) / tension unit (length adjustment)	17
Schmier-Station / lubrication unit	18

Power&Free-Förderer / conveyor K8-2

Gerade Laufschiene / straight tracks	19
Laufschiene-Bögen / curve tracks	20
Weichen / track switches	21
Anbau an Weichen / extension for track switches (KIG - EIB)	24
Mitnehmer / pusher dog	25
Schleppketten-Antrieb / caterpillar drive unit	26
Kontroll-Montage-Schiene / control assembly rail	27
Spann-Station (Längenausgleich) / tension unit (length adjustment)	27
Schmier-Station / lubrication unit	28
Stopp-Station / stop station	29
Rücklaufsperrern / runback stoppers	30
Transportwagen / trolleys	32
Traverse / loadbar	33
Einschub / pusher	34

Lieferprogramm / Product range 35

Gerade Laufschienen / straight tracks

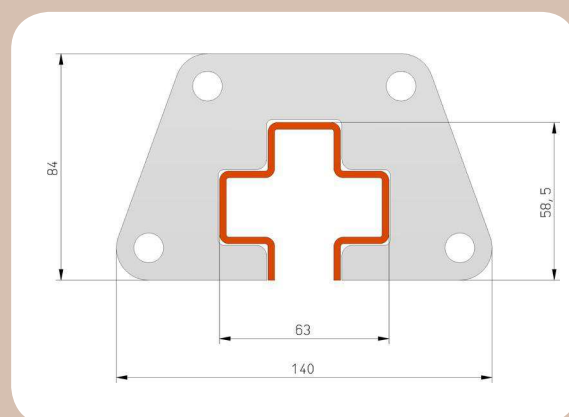
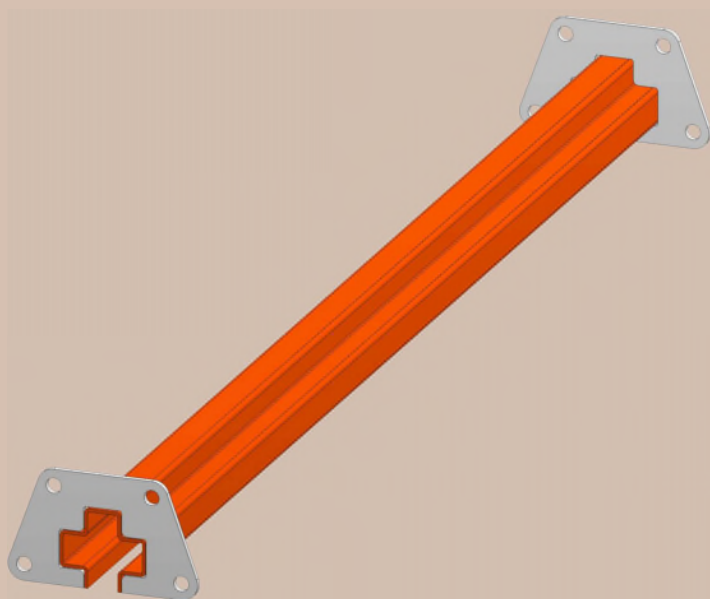

TFX 081-L110-100 / L ...

Länge / length (L)	TFX Code
Standard 3000 mm	... / L3000
50 bis / to 2999 mm	... / L ...

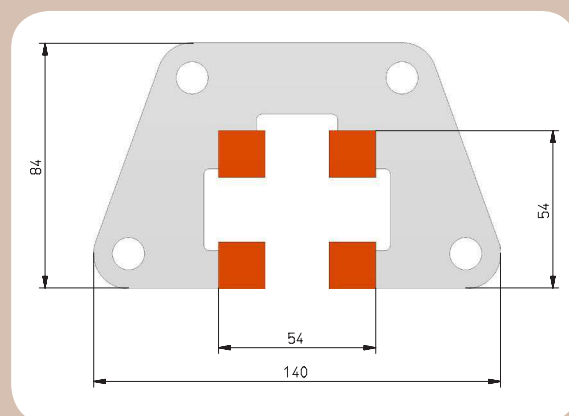
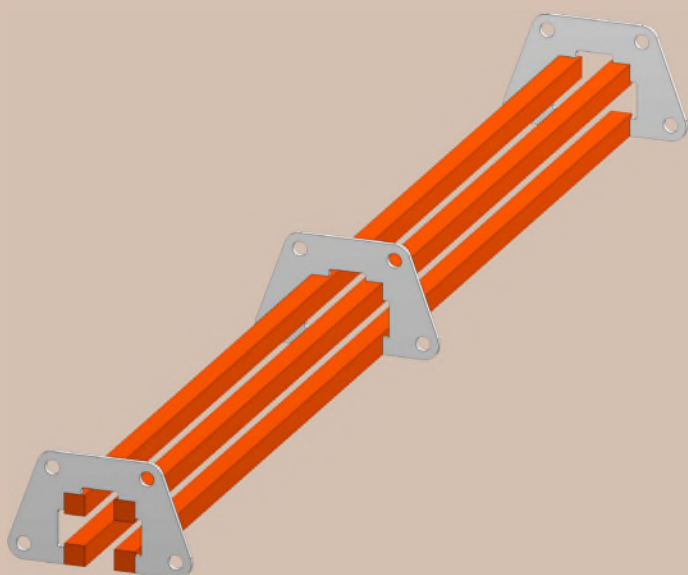

TFX 081-L120-100 / L ...

Länge / length (L)	TFX Code
Standard 3000 mm	... / L3000
50 bis / to 2999 mm	... / L ...

Flansch-Teilung / Flange pitch ca. 500mm

Laufschienen-Bögen / Curve tracks

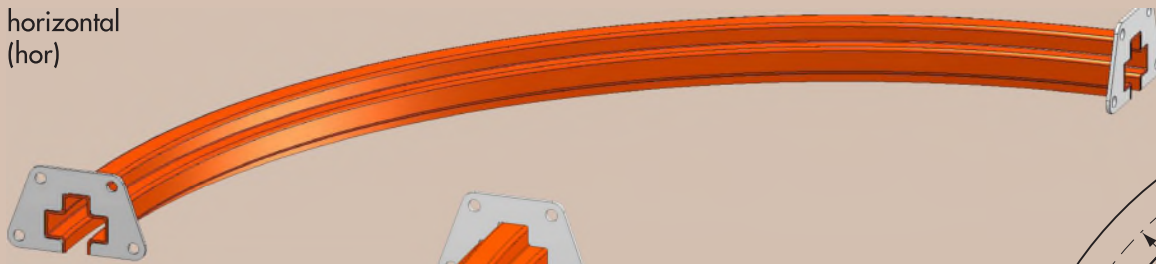
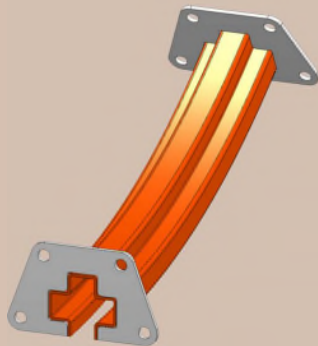
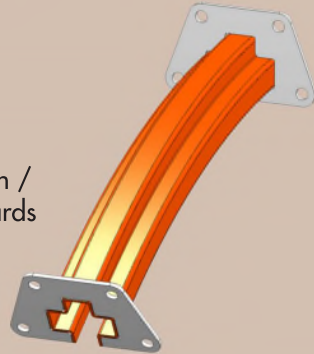
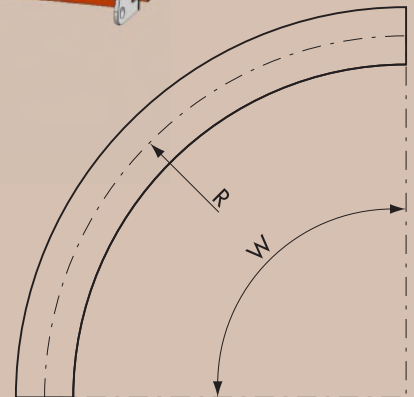
horizontal
(hor)vertikal innen /
vertical inwards
(vin)vertikal außen /
vertical outwards
(vau)**TFX 081-L211- ... (hor)****TFX 081-L212- ... (vin)****TFX 081-L213- ... (vau)**

Radius (R)	Winkel / angle (W)	TFX Code
780 mm	90°	... -190
	60°	... -160
	45°	... -145
	30°	... -130
	15°	... -115

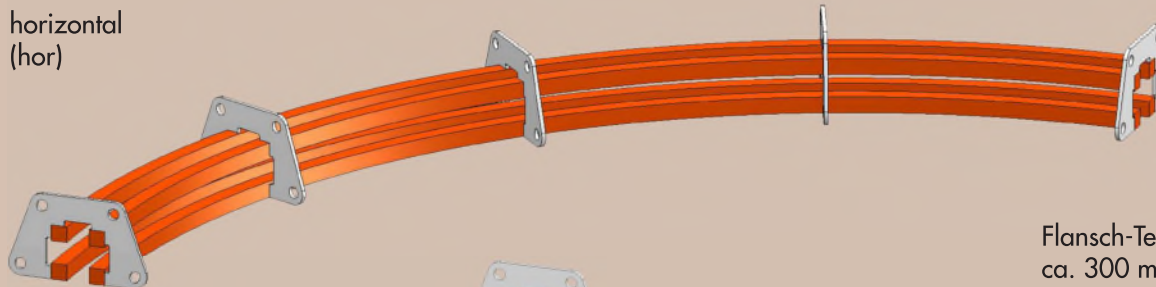
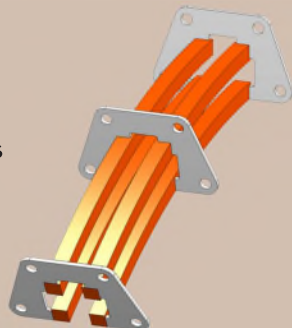
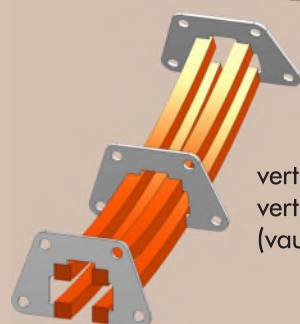
horizontal
(hor)Flansch-Teilung / flange pitch
ca. 300 mmvertikal innen /
vertical inwards
(vin)vertikal außen /
vertical outwards
(vau)**TFX 081-L221- ... / R ... (hor)****TFX 081-L222- ... / R ... (vin)****TFX 081-L223- ... / R ... (vau)**

Radius (R)	Winkel / angle (W)	TFX Code
250 mm	90°	... -190 / R250
	60°	... -160 / R ...
bis / to 2000 mm	45°	... -145 / R ...
	30°	... -130 / R ...
	15°	... -115 / R ...

Förderketten / Conveyor chains

Teilung / pitch 200 mm

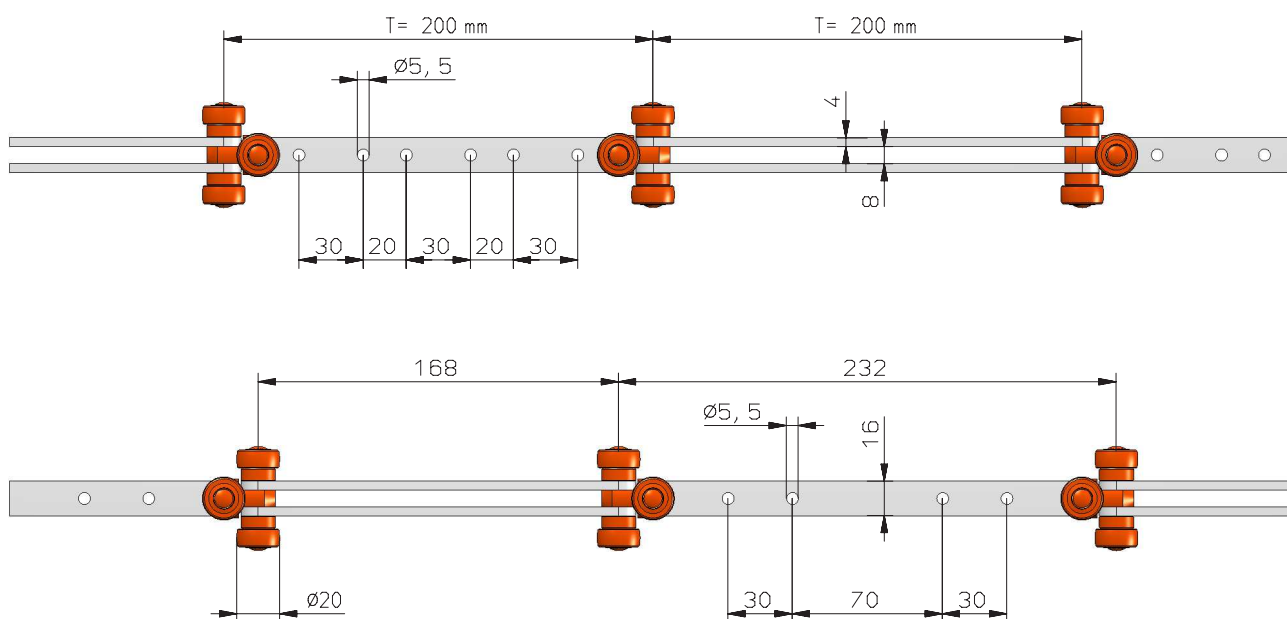
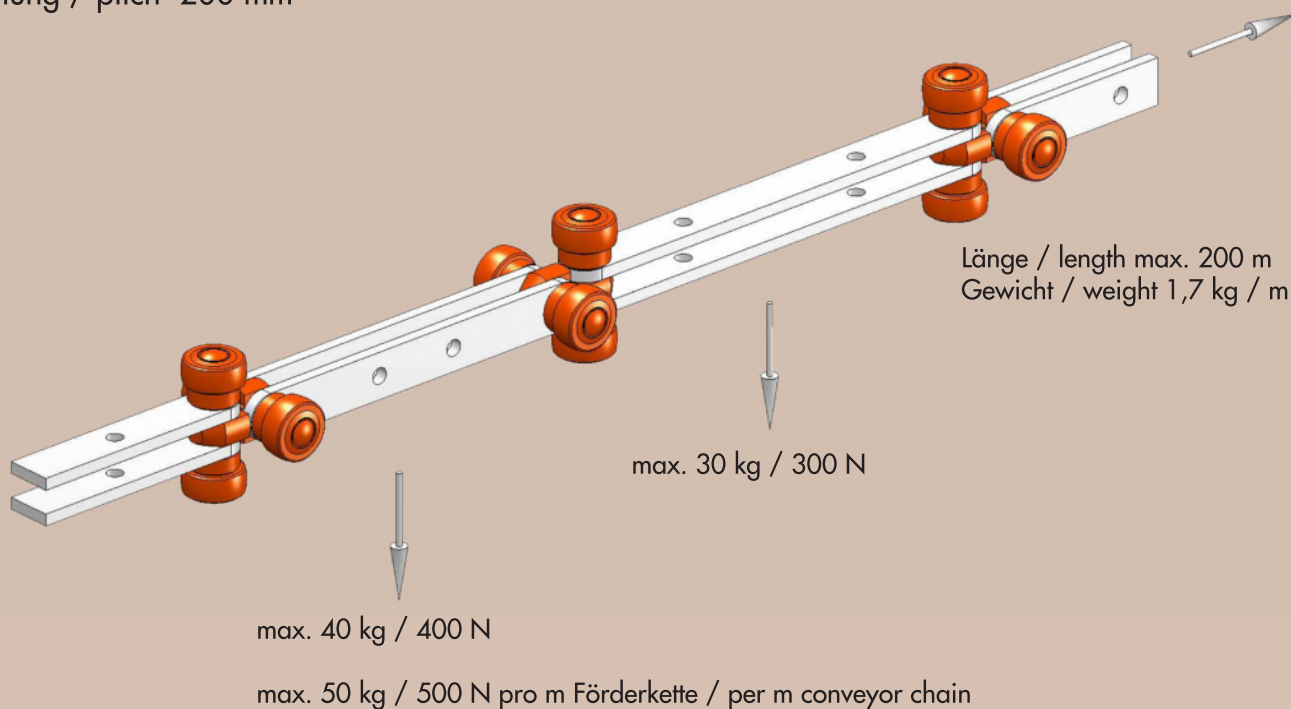

TFX 081-K111-001 / L ... (T max 120°C)

TFX 081-K112-001 / L ... (T max 240°C)

Kleinsten Bogen-Radius / minimum curve track radius :

780 mm horizontal

500 mm vertikal / vertical

Länge / length (L)	TFX Code
Standard 6000 mm	... / L6000
400 bis / to 5600 mm	... / L ...

Teilung / pitch 150 mm

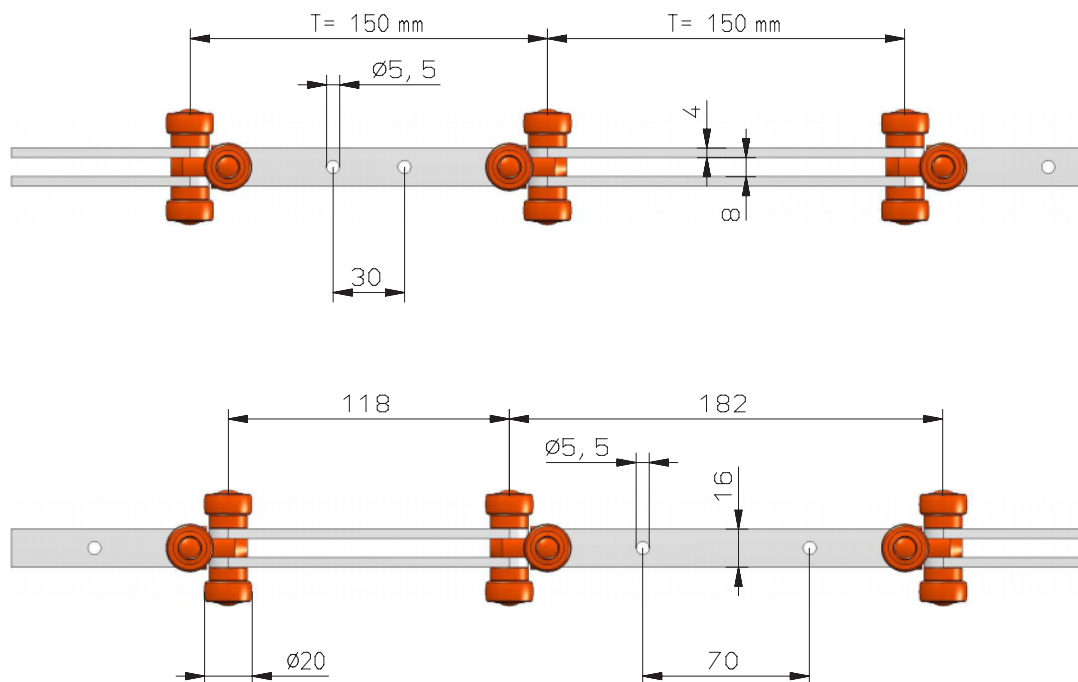
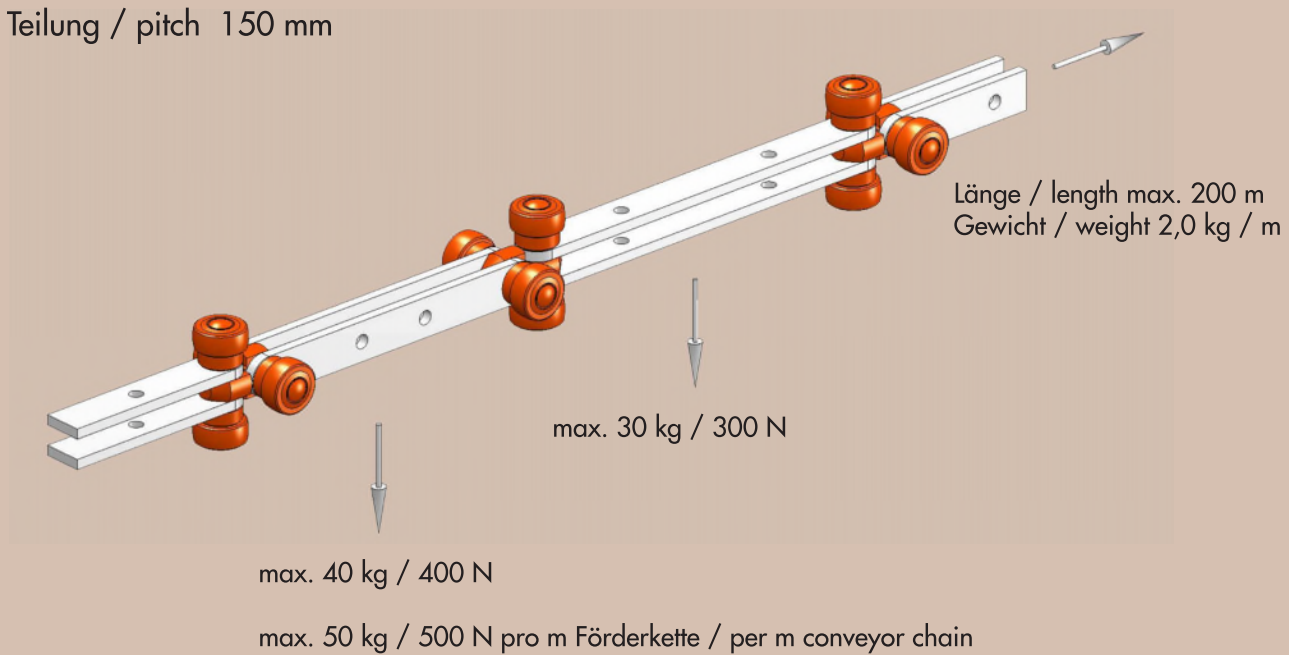

TFX 081-K121-001 / L ... (T max 120°C)

TFX 081-K122-001 / L ... (T max 240°C)

Kleinsten Bogen-Radius / minimum curve track radius :

500 mm horizontal

350 mm vertikal / vertical

Länge / length (L)	TFX Code
Standard 6000 mm	... / L6000
300 bis / to 5700 mm	... / L ...

Teilung / pitch 100 mm

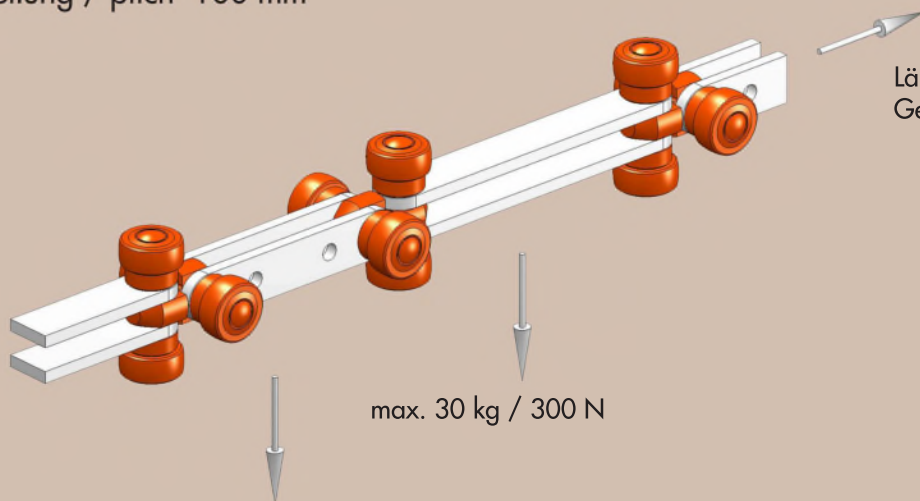

Länge / length max. 200 m
Gewicht / weight 2,4 kg / m

max. 40 kg / 400 N

max. 30 kg / 300 N

max. 50 kg / 500 N pro m Förderkette / per m conveyor chain

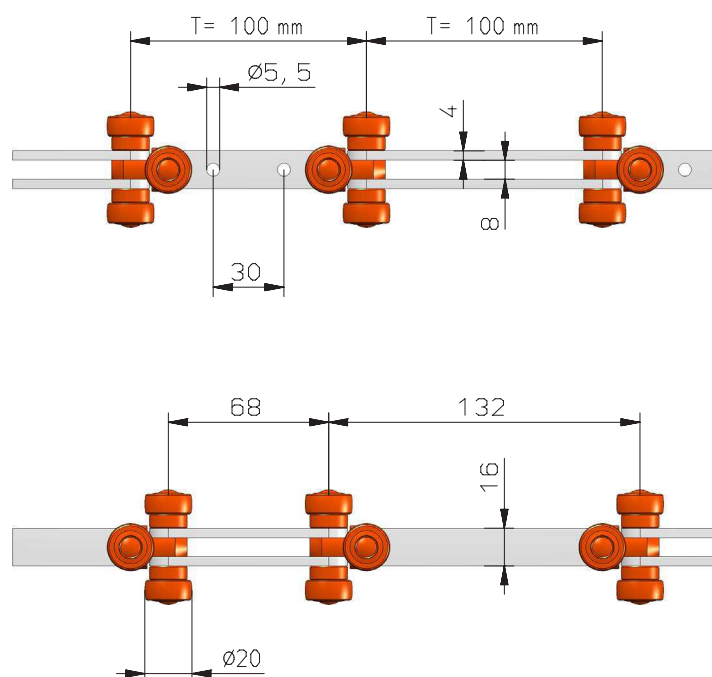

TFX 081-K131-001 / L ... (T max 120°C)
TFX 081-K132-001 / L ... (T max 240°C)

Kleinster Bogen-Radius / minimum curve track radius :
250 mm horizontal
150 mm vertikal / vertical

Länge / length (L)	TFX Code
Standard 6000 mm	... / L6000
200 bis / to 5800 mm	... / L ...

Hängerblech / hanger plate

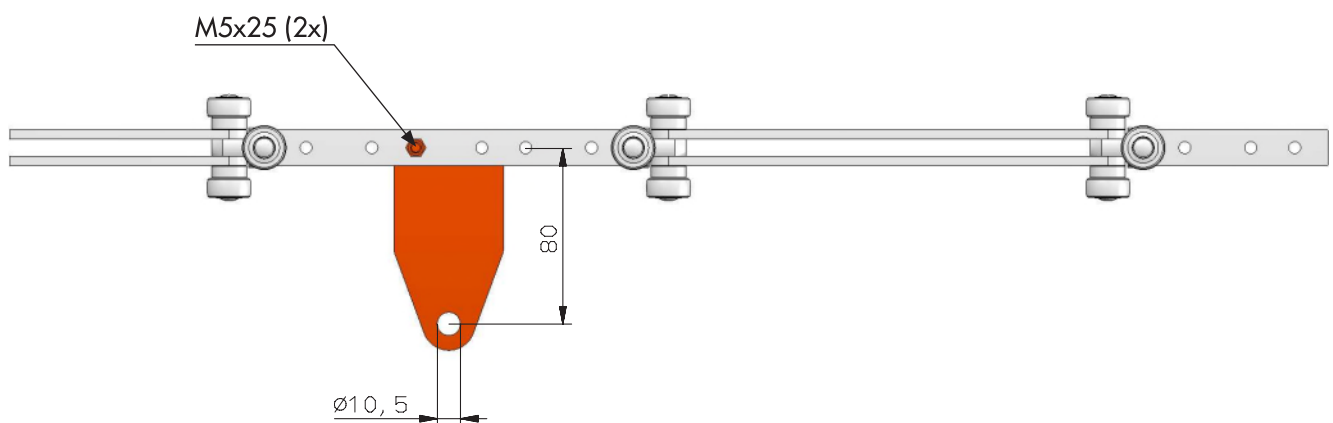
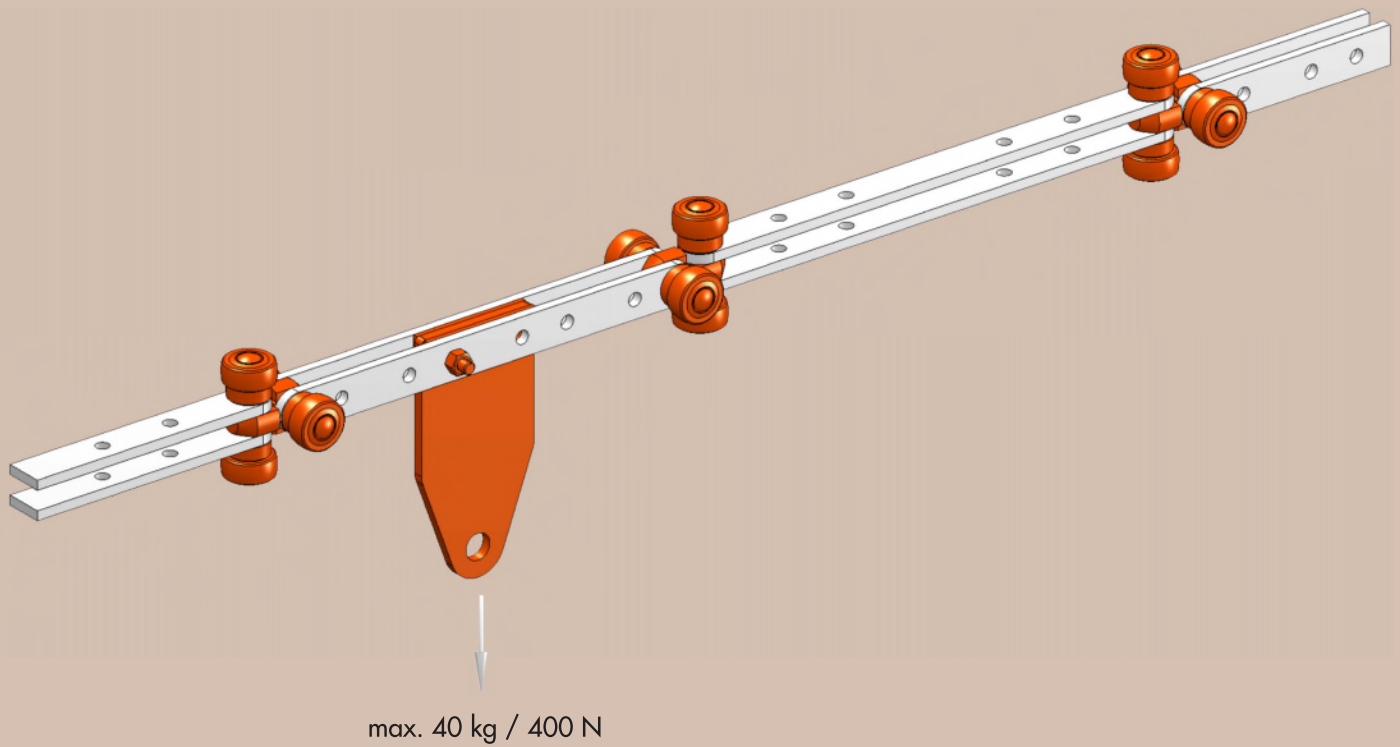

TFX 081-T111-001

Schleppketten-Antrieb / caterpillar drive unit

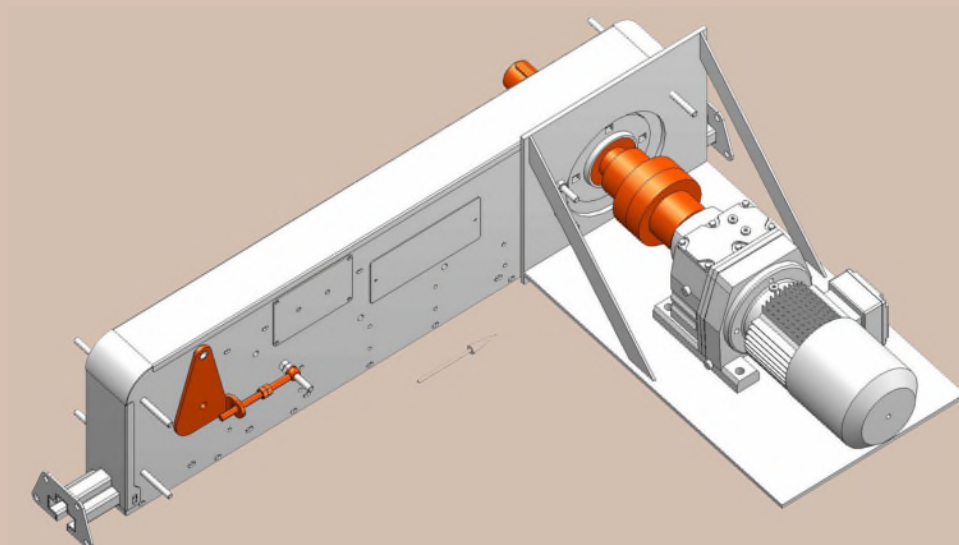

Antrieb mit Rutsch-Kupplung und
Getriebe-Motor /

Drive unit with friction clutch and
electric motor

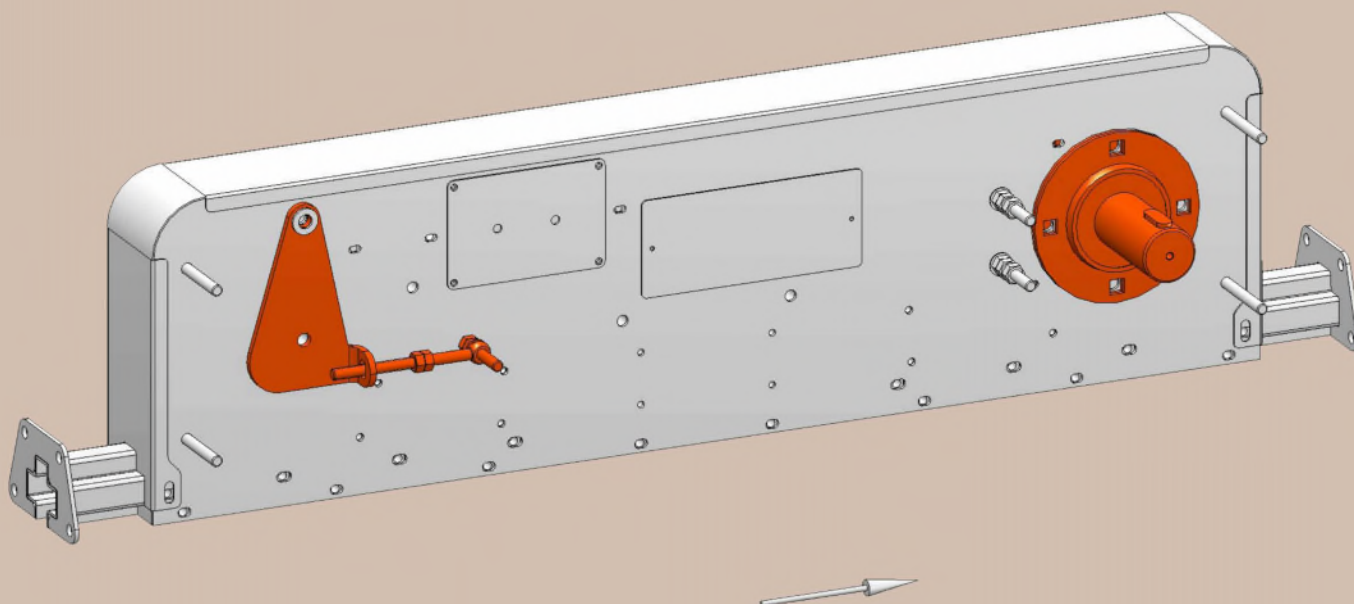

Fördergut-Gewicht / conveyed products weight

pro m Förderkette / per m conveyor chain max. 50 kg / 500 N
pro Schleppketten-Antrieb / per drive unit max. 2500 kg / 25 kN

TFX 081-A110-001 (T= 200 mm)

TFX 081-A130-001 (T= 100 mm)

Einbau-Länge / installation length (L)
--

Standard 1225 mm

TFX 081-A120-001 (T= 150 mm)

Einbau-Länge / installation length (L)
--

Standard 1275 mm

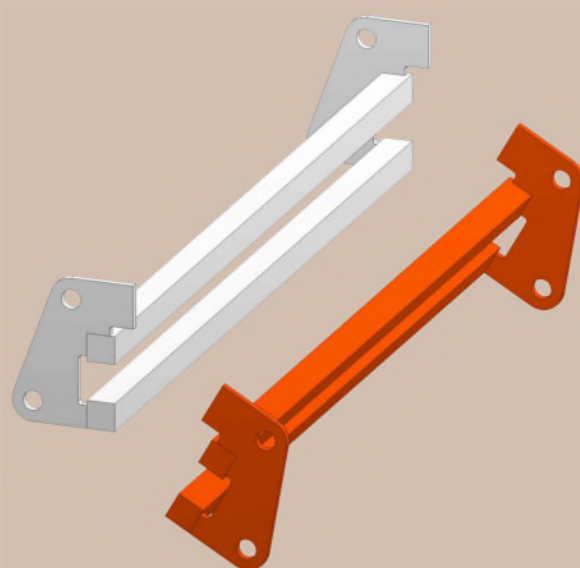
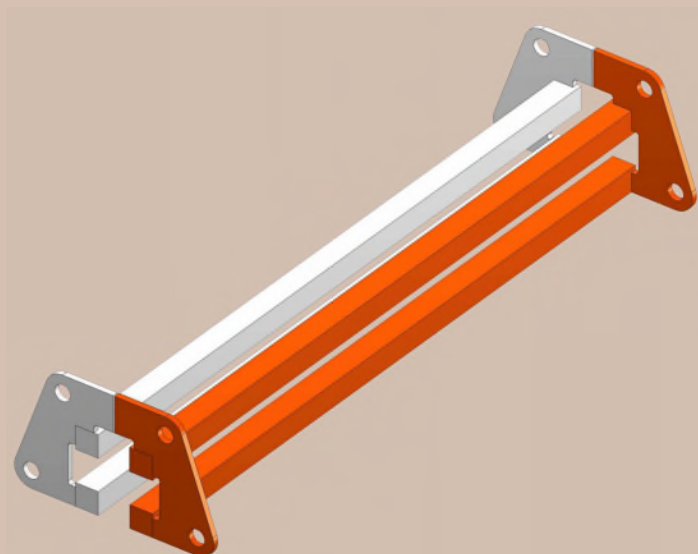
Kontroll-Montage-Schiene / control assembly rail**TFX 081-F110-001**

Einbau-Länge / installation length (L)
Standard 450 mm

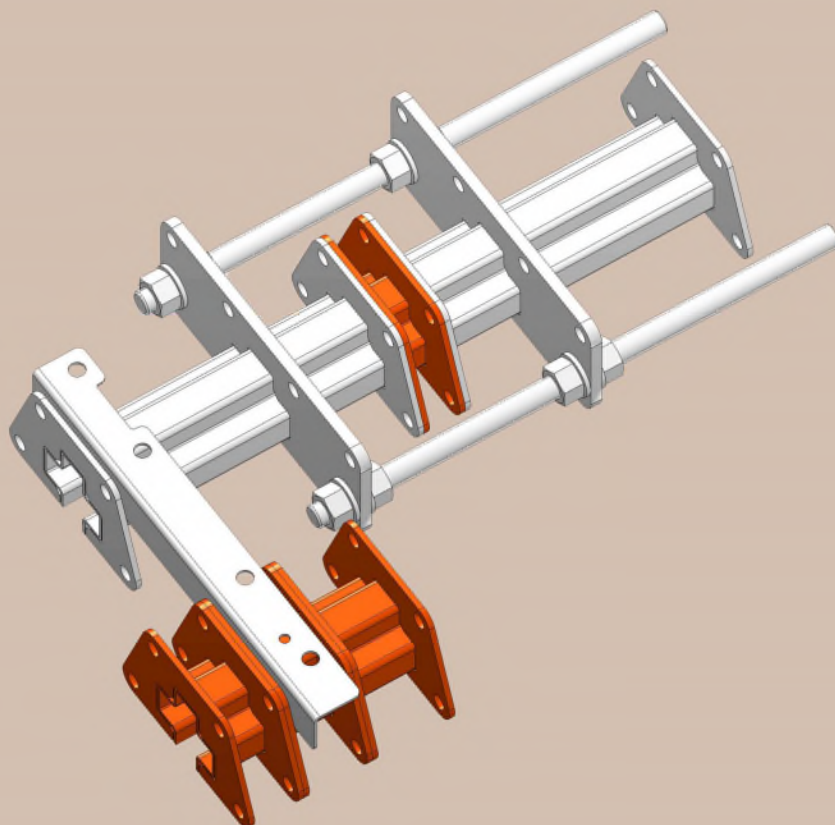
Spann-Station (Längenausgleich) / tension unit (length adjustment)**TFX 081-F211-001**

Einbau-Länge / installation length (L)
Standard 450 mm
min. 420 mm (- 30 mm)
max. 600 mm (+ 40, 50, 60 mm)

Schmier-Station / lubrication unit

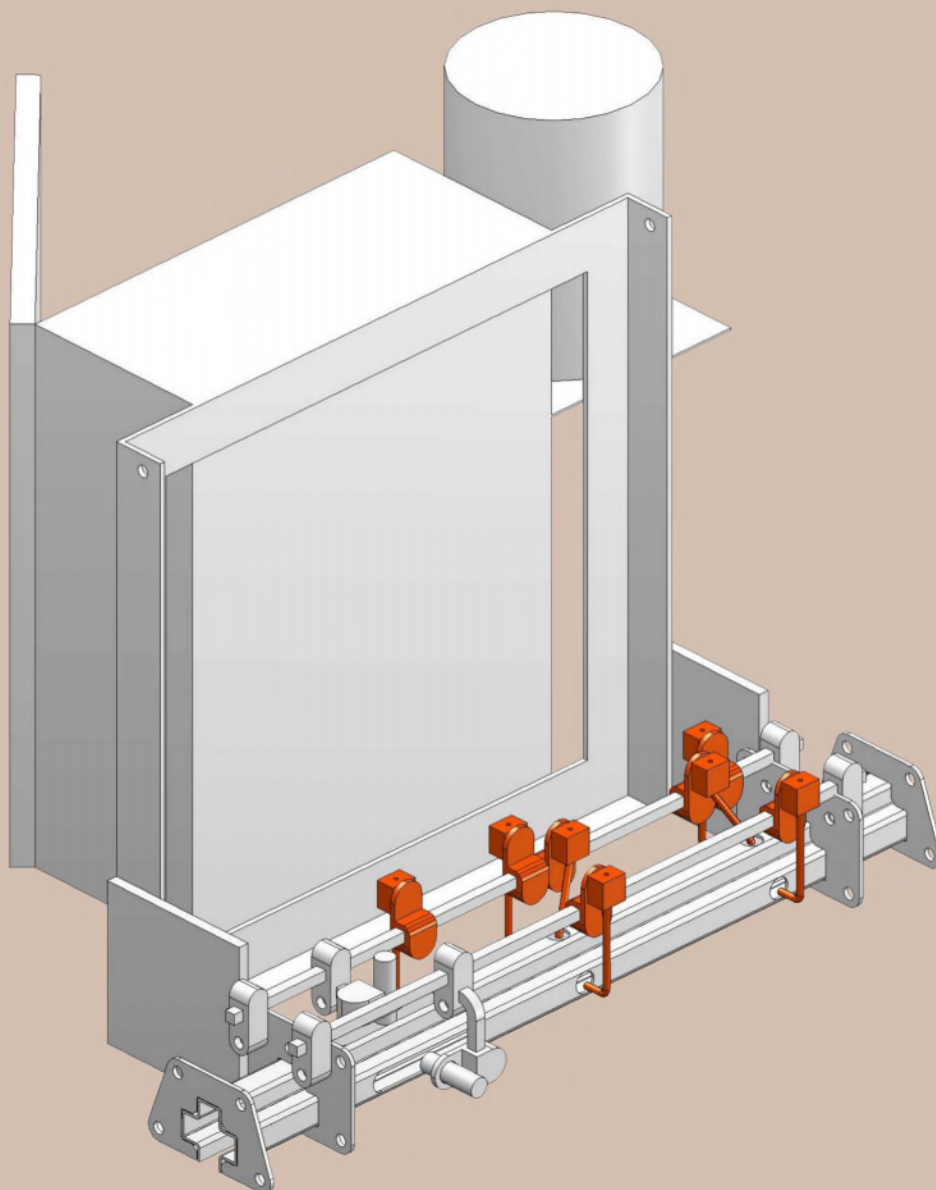

TFX 081-F310-001 (T= 200 mm)

TFX 081-F320-001 (T= 150 mm)

TFX 081-F330-001 (T= 100 mm)

Einbau-Länge / installation length (L)
Standard 750 mm

Gerade Laufschienen / straight tracks

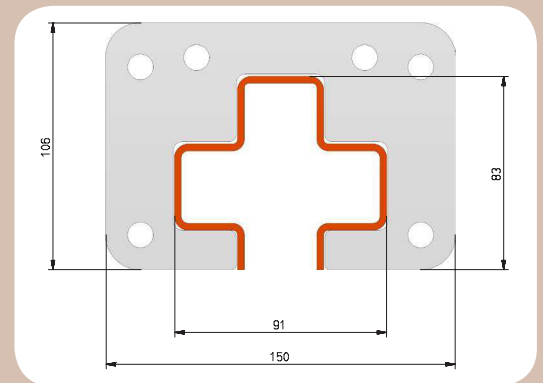
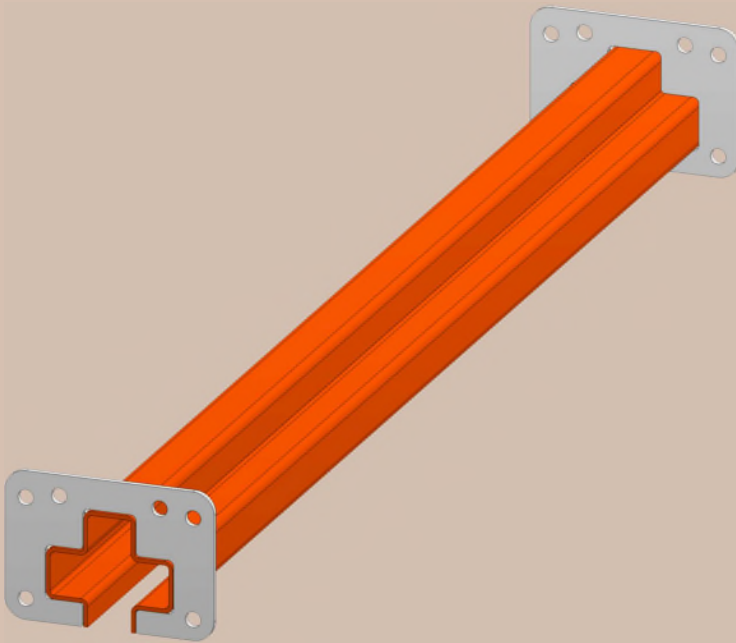

TFX 101-L110-100 / L ...

Länge / length (L)	TFX Code
Standard 3000 mm	... / L3000
50 bis / to 2999 mm	... / L ...

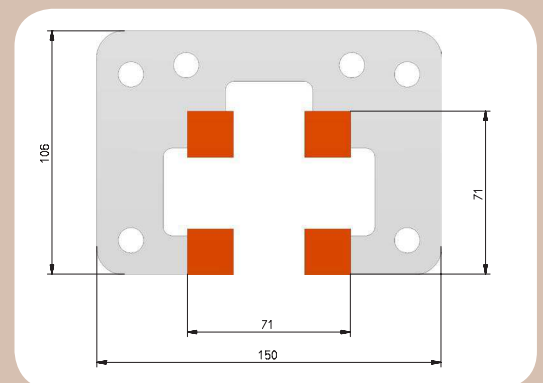
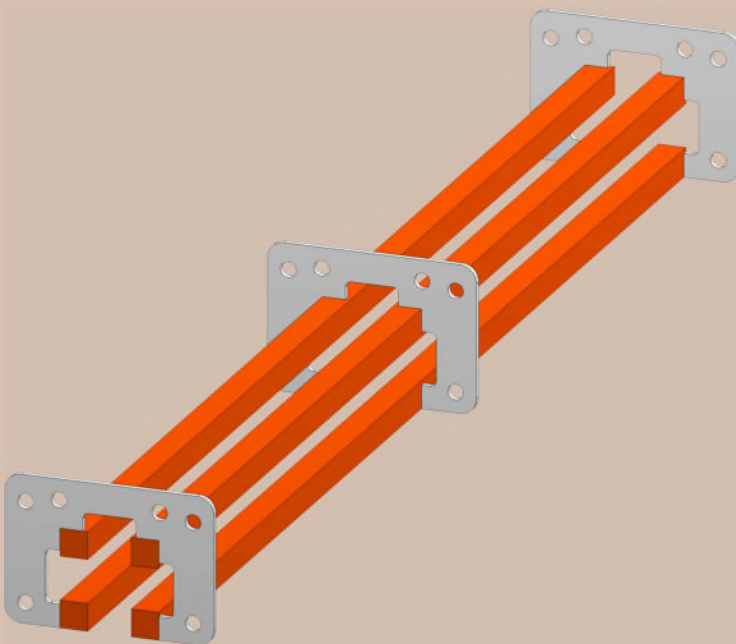

TFX 101-L120-100 / L ...

Länge / length (L)	TFX Code
Standard 3000 mm	... / L3000
50 bis / to 2999 mm	... / L ...

Laufschienen-Bögen / curve tracks

horizontal
(hor)

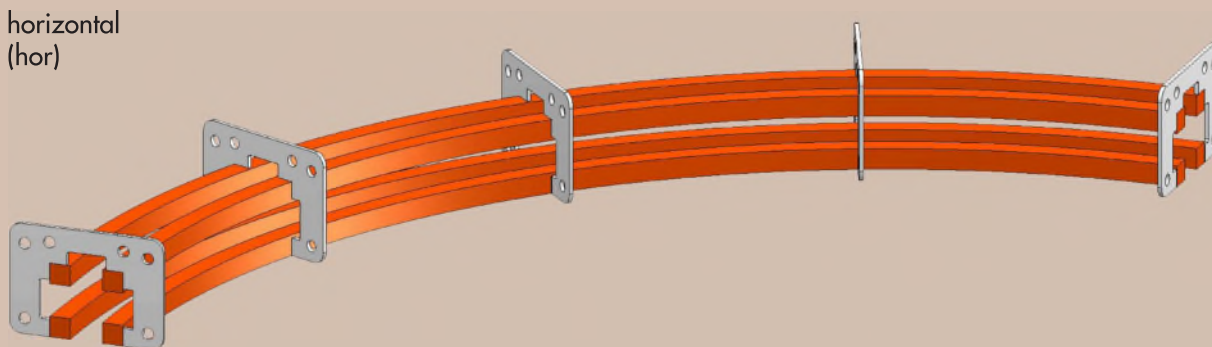

vertikal innen /
vertical inwards
(vin)

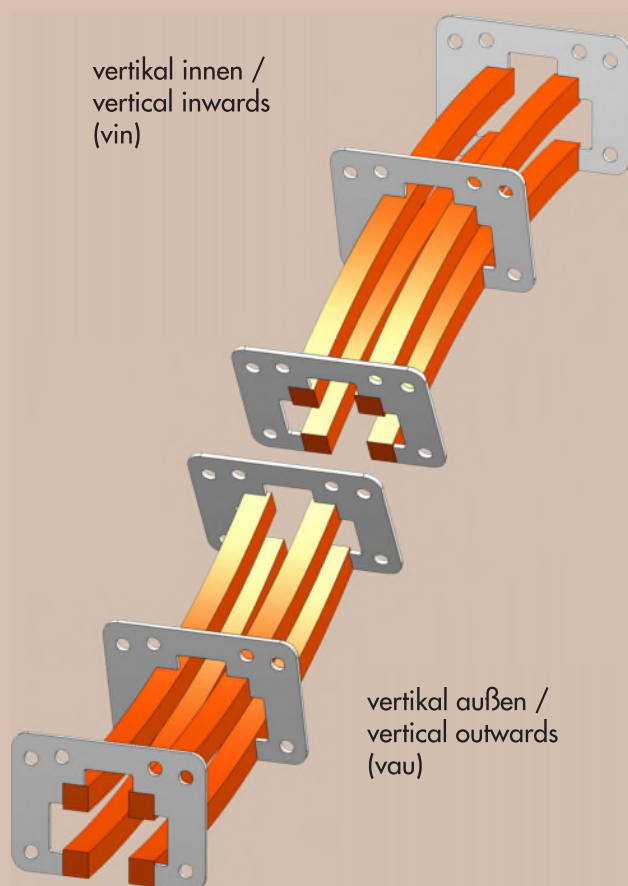

vertikal außen /
vertical outwards
(vau)

Flansch-Teilung / flange pitch
ca. 300 mm

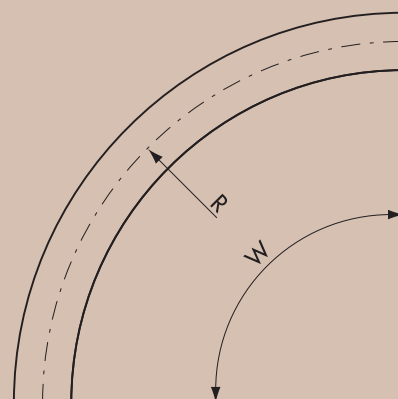

TFX 101-L221- ... / R ... (hor)

TFX 101-L222- ... / R ... (vin)

TFX 101-L223- ... / R ... (vau)

Radius (R)	Winkel / angle (W)	TFX Code
250 mm	90°	... -190 / R250
	60°	... -160 / R ...
bis / to	45°	... -145 / R ...
2000 mm	30°	... -130 / R ...
	15°	... -115 / R ...

Förderketten / conveyor chains

Teilung / pitch 200 mm

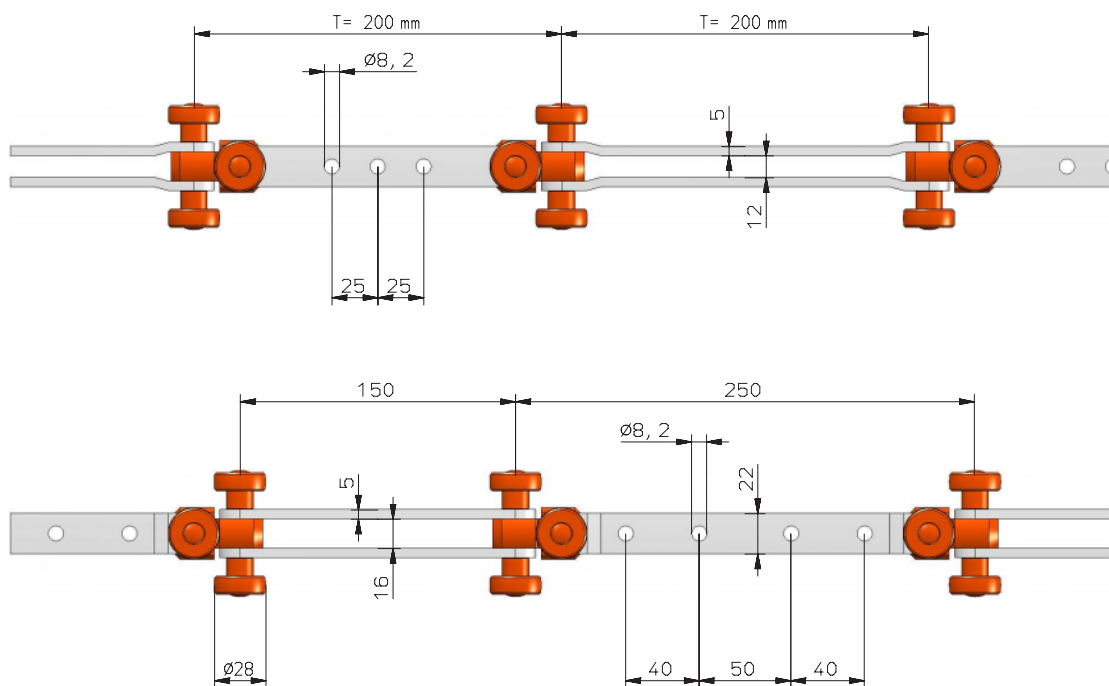
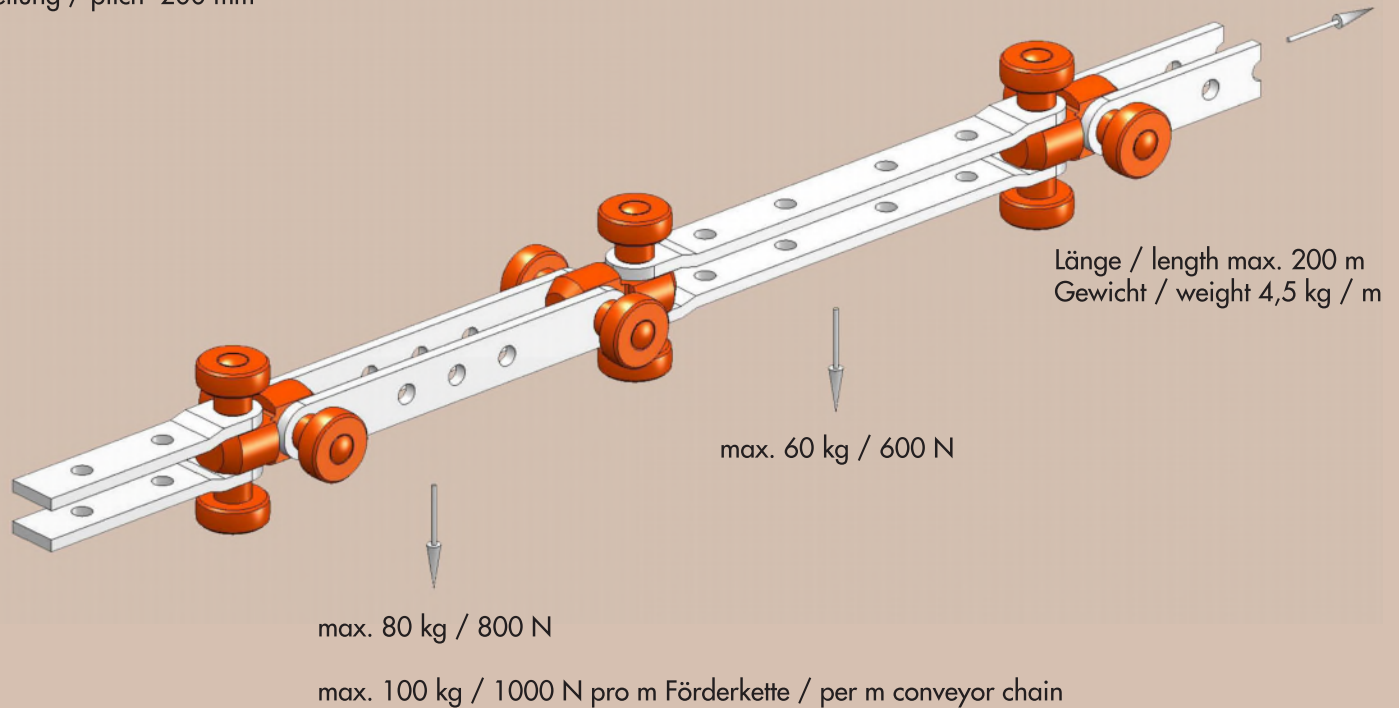

TFX 101-K111-001 / L ... (T max 120°C)

TFX 101-K112-001 / L ... (T max 240°C)

Kleinster Bogen-Radius / minimum curve track radius :

780 mm horizontal

500 mm vertikal / vertical

Länge / length (L)	TFX Code
Standard 6000 mm	... / L6000
400 bis / to 5600 mm	... / L ...

Hängerblech / hanger plate

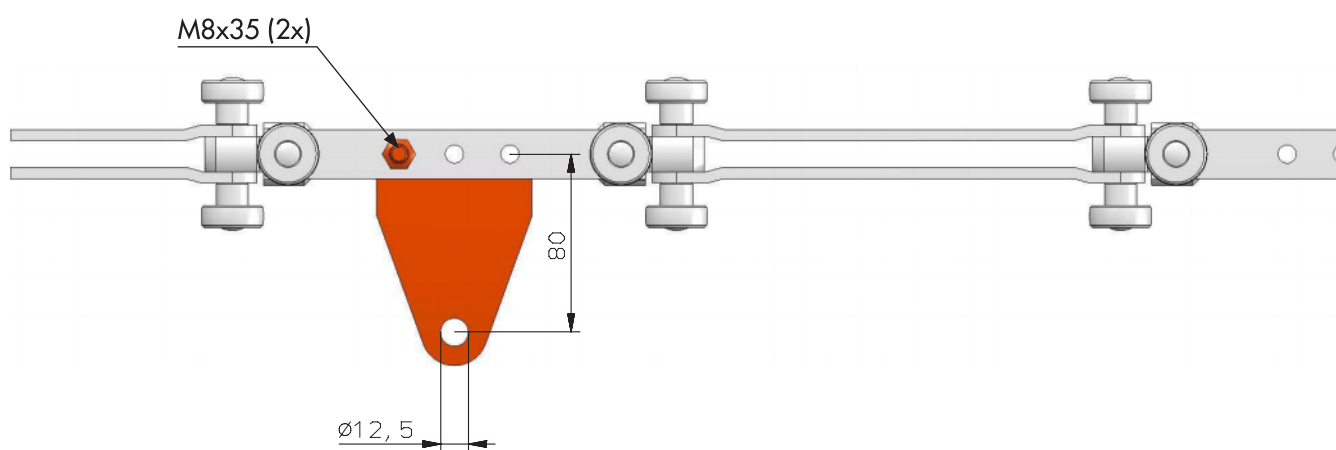
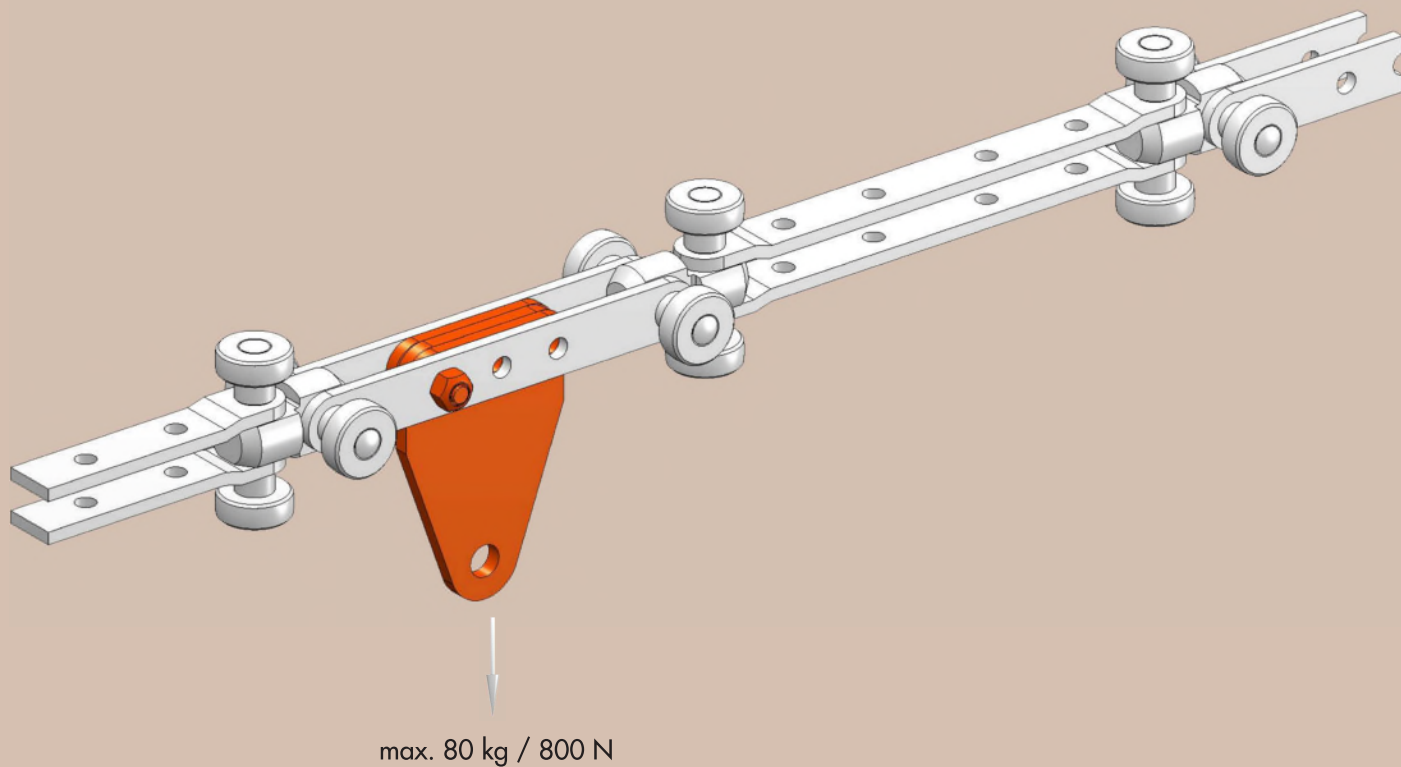

TFX 101-T111-001

Schleppketten-Antrieb / caterpillar drive unit

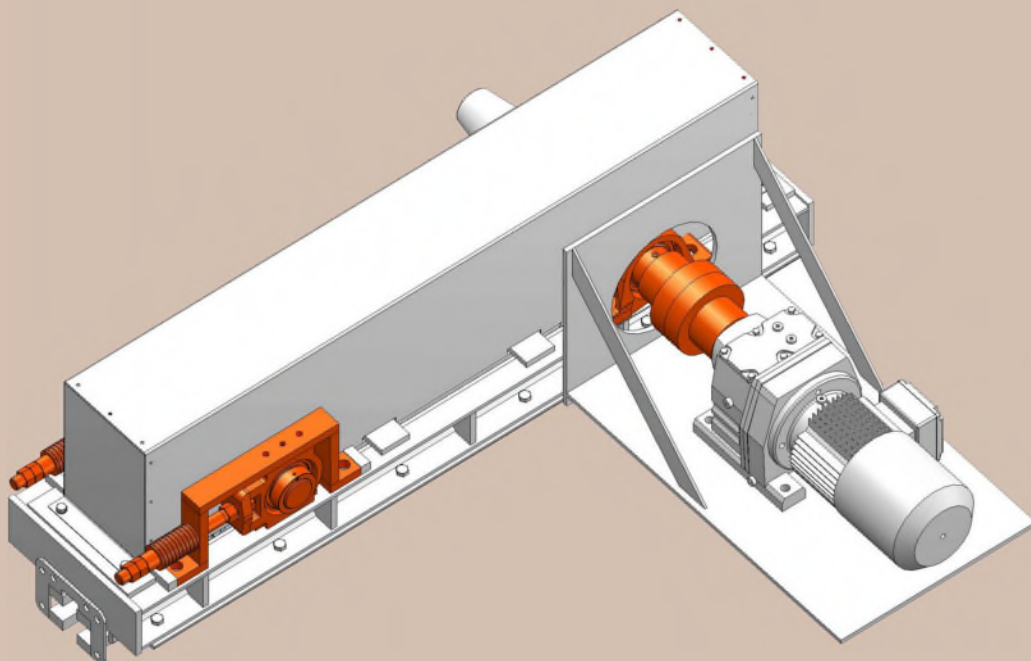

Antrieb mit Rutsch-Kupplung und
Getriebe-Motor /

Drive unit with friction clutch and
electric motor

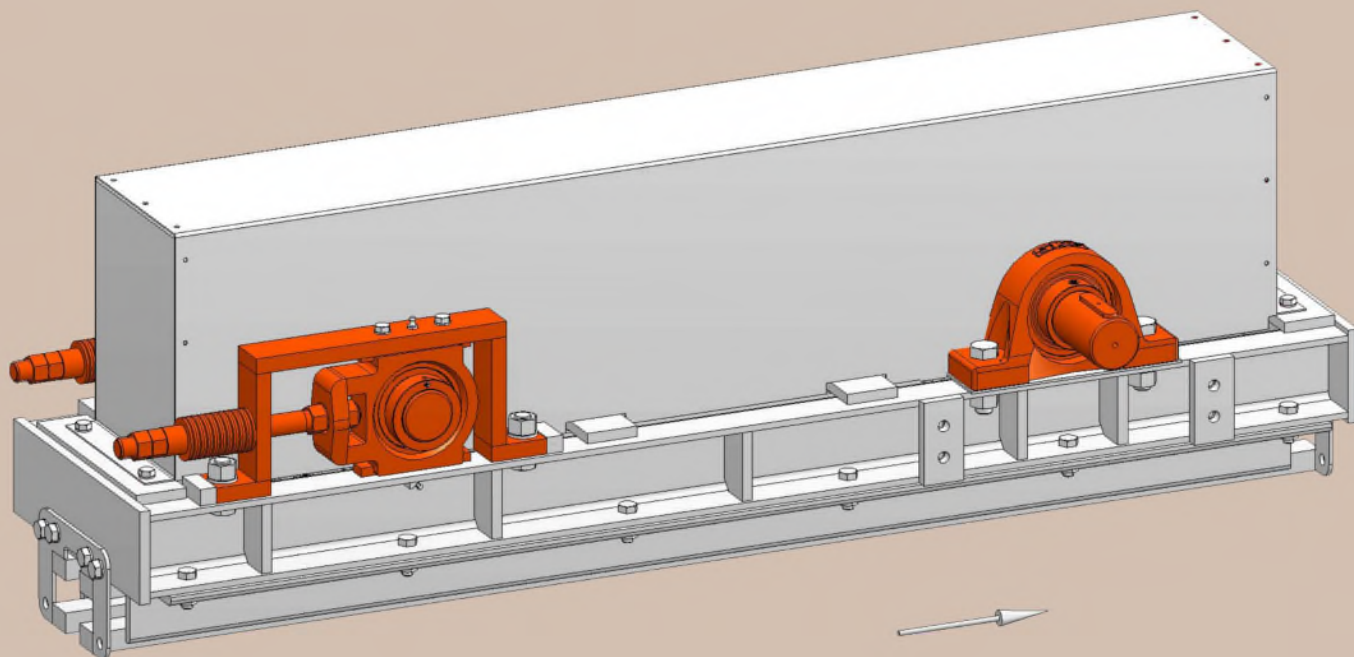

Fördergut-Gewicht / conveyed products weight

pro m Förderkette / per m conveyor chain max. 100 kg / 1000 N
pro Schleppketten-Antrieb / per drive unit max. 12000 kg / 120 kN

TFX 101-A110-001 (T= 200 mm)

Einbau-Länge / installation length (L)
--

Standard 1225 mm

Kontroll-Montage-Schiene / control assembly rail

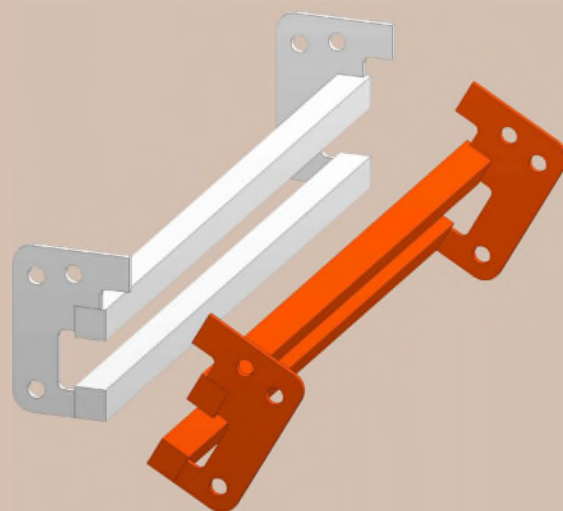
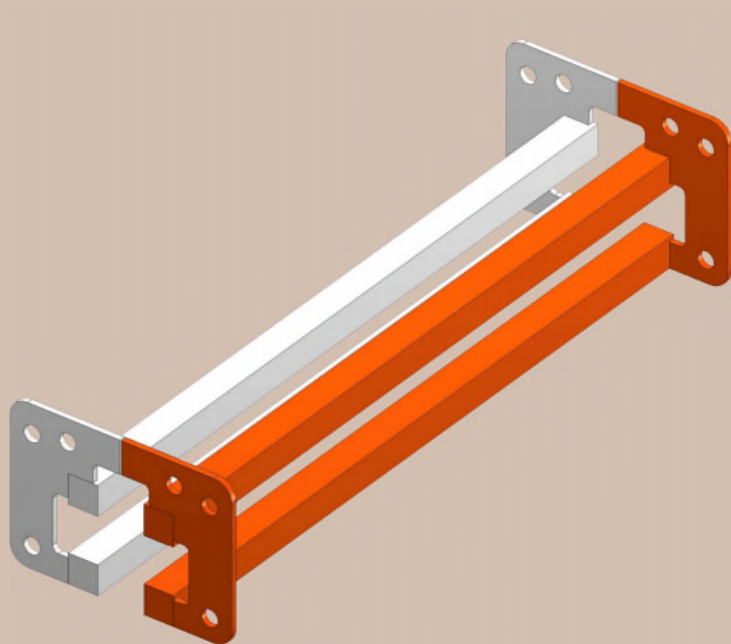

TFX 101-F110-001

Einbau-Länge / installation length (L)
Standard 450 mm

Spann-Station (Längenausgleich) / tension unit (length adjustment)

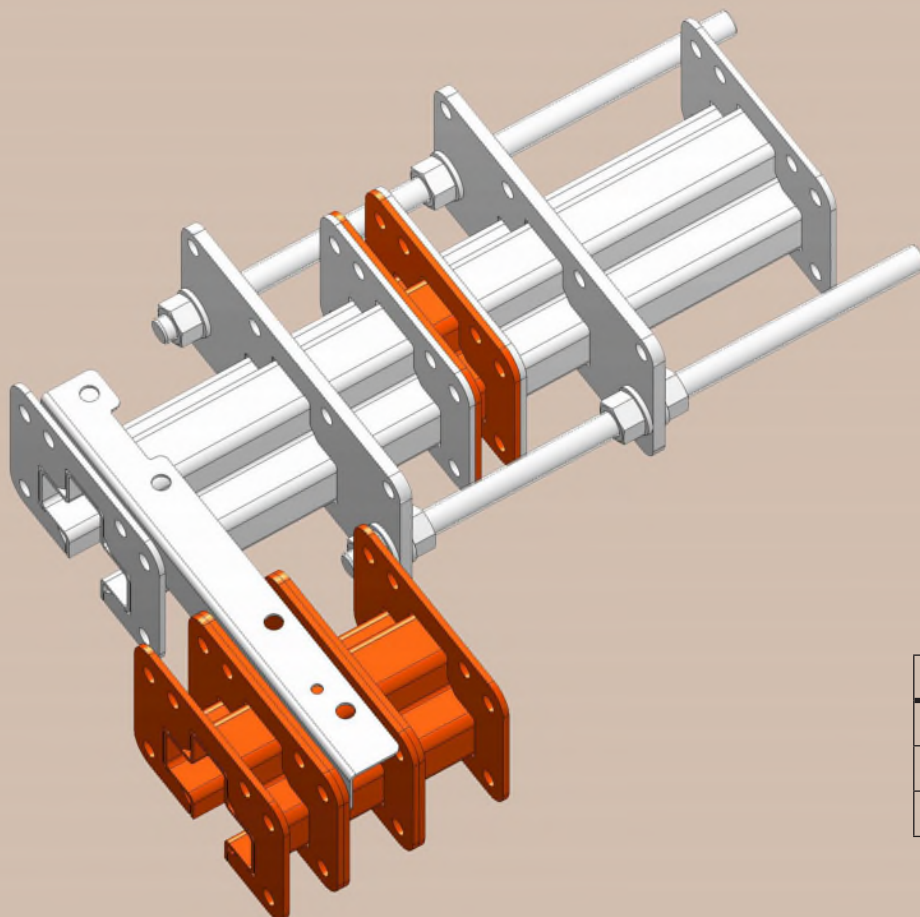

TFX 101-F211-001

Einbau-Länge / installation length (L)
Standard 450 mm
min. 420 mm (- 30 mm)
max. 600 mm (+ 40, 50, 60 mm)

Schmier-Station / Lubrication unit

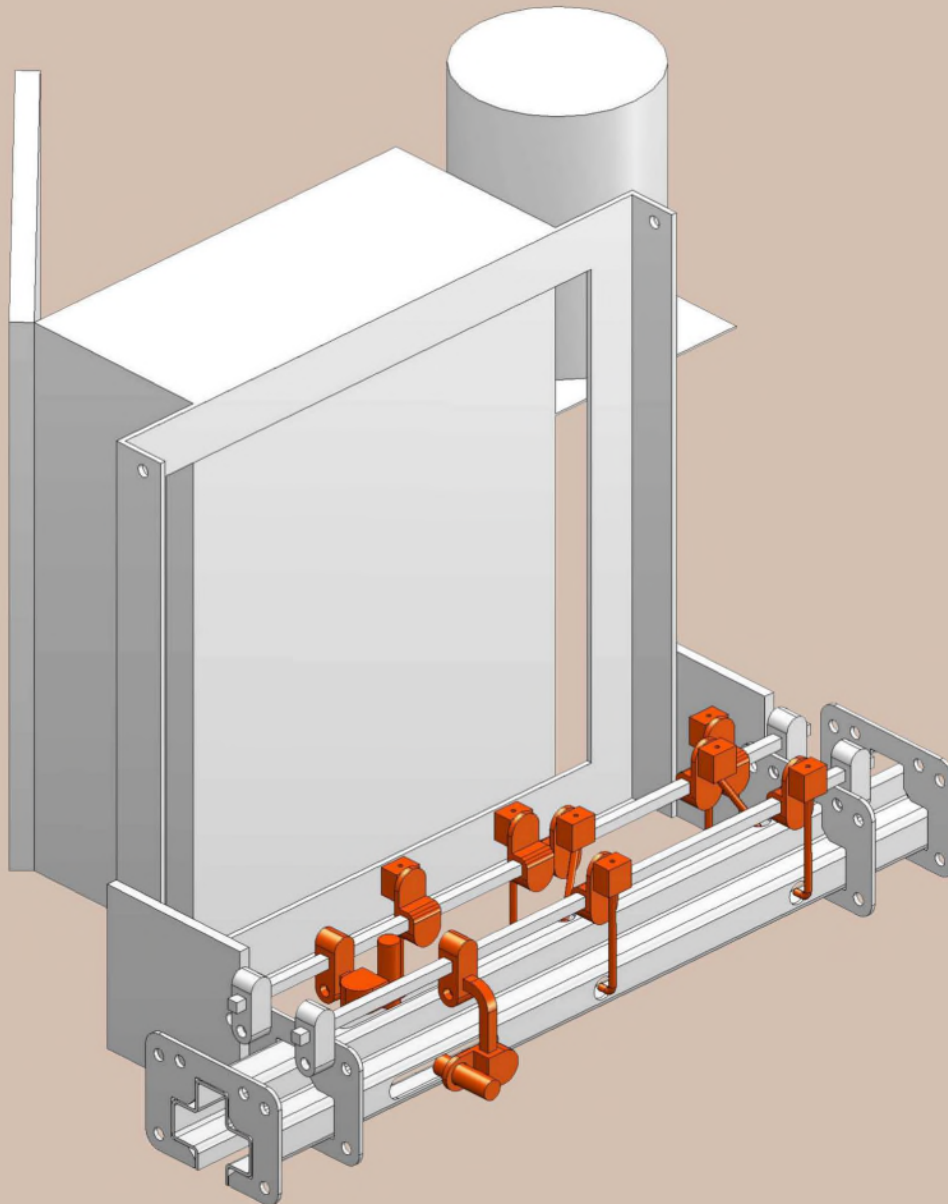
**TFX 101-F310-001 (T= 200 mm)**

Einbau-Länge / installation length (L)

Standard 750 mm

Gerade Laufschienen / straight tracks

Flansch-Teilung / flange pitch
ca. 500 mm

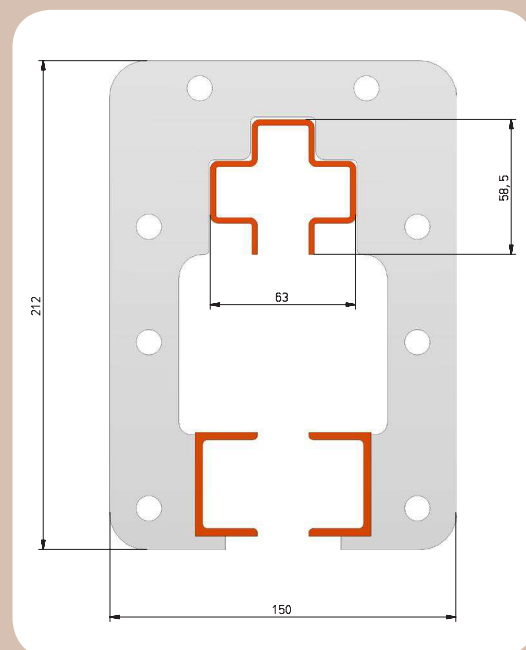
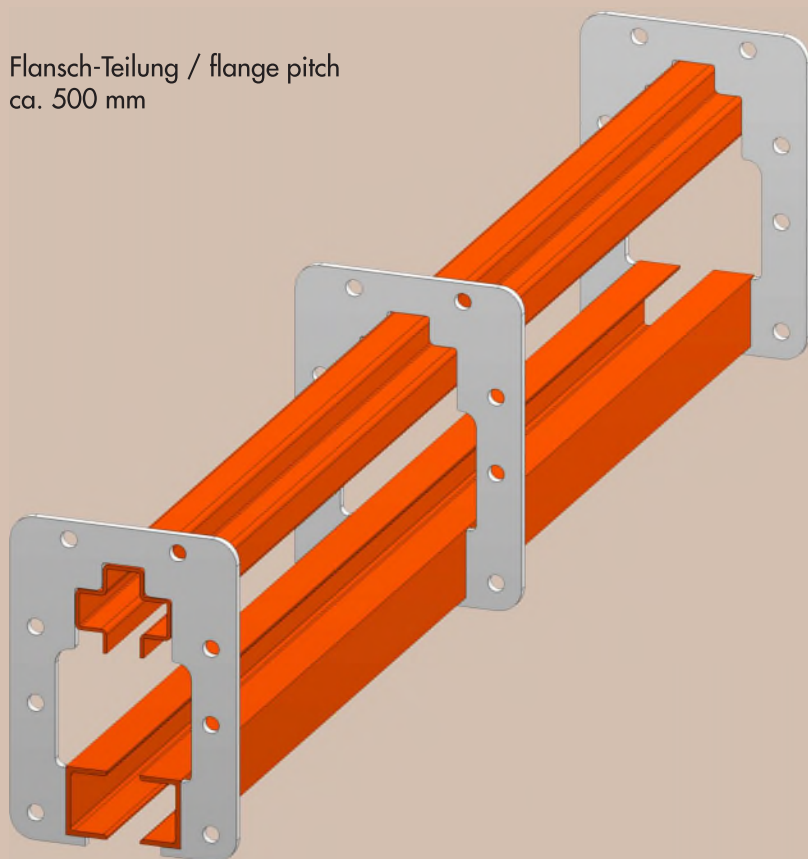
**TFX 082-L110-100 / L ...**

Länge / length (L)	TFX Code
Standard 3000 mm	... / L3000
50 bis / to 2999 mm	... / L ...

Laufschienen-Bögen / curve tracks

horizontal
(hor)

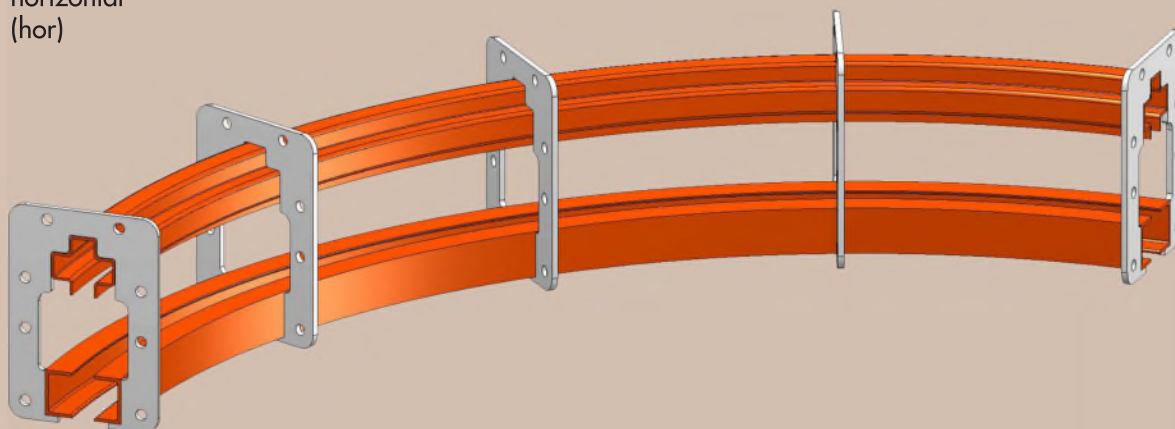

vertikal innen /
vertical inwards
(vin)

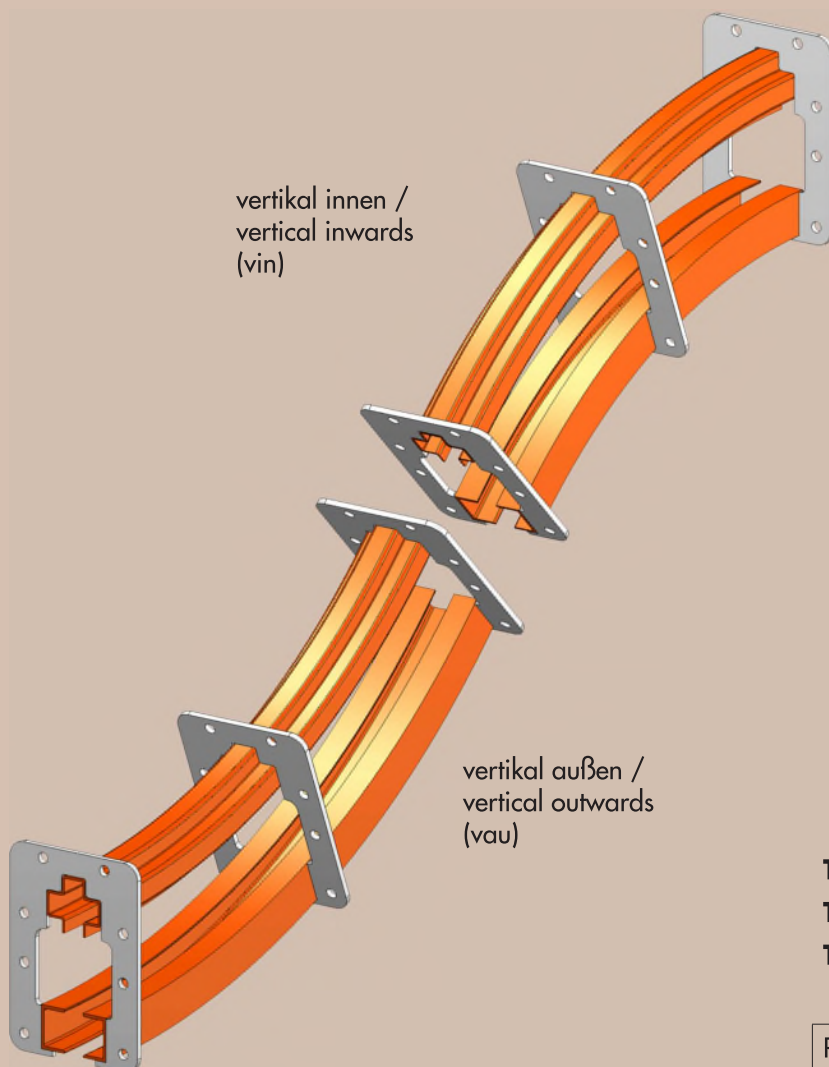

vertikal außen /
vertical outwards
(vau)

Flansch-Teilung / flange pitch
ca. 300 mm

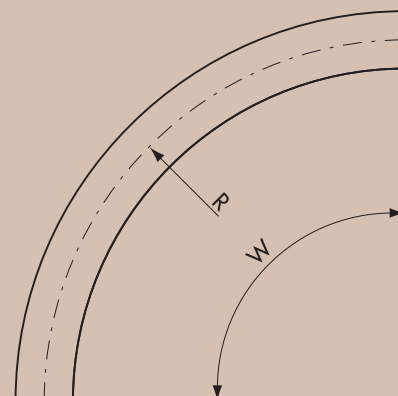

TFX 082-L221- ... (hor)

TFX 082-L222- ... (vin)

TFX 082-L223- ... (vau)

Radius (R)	Winkel / angle (W)	TFX Code
780 mm	90°	... -190
	60°	... -160
	45°	... -145
	30°	... -130
	15°	... -115

Weichen / track switches

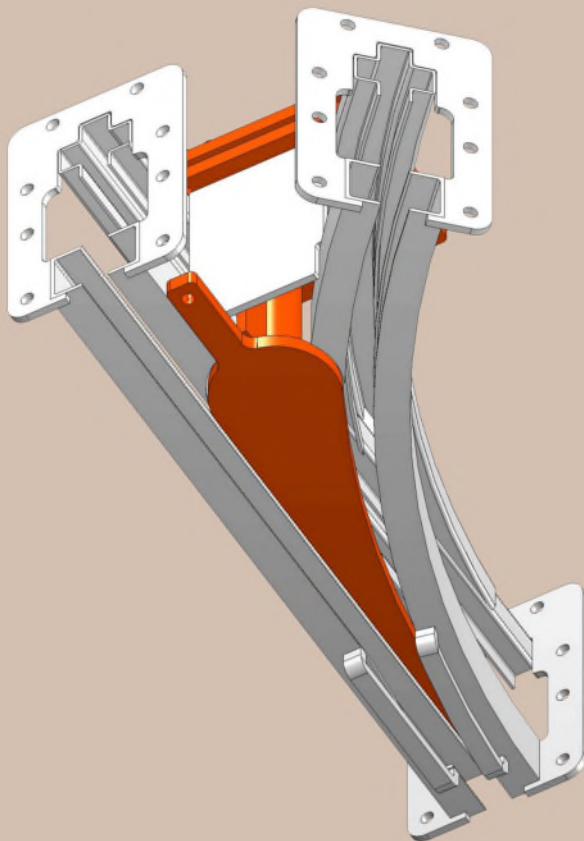

Ungesteuert /
non-controlled

Pneumatisch gesteuert /
pneumatically controlled

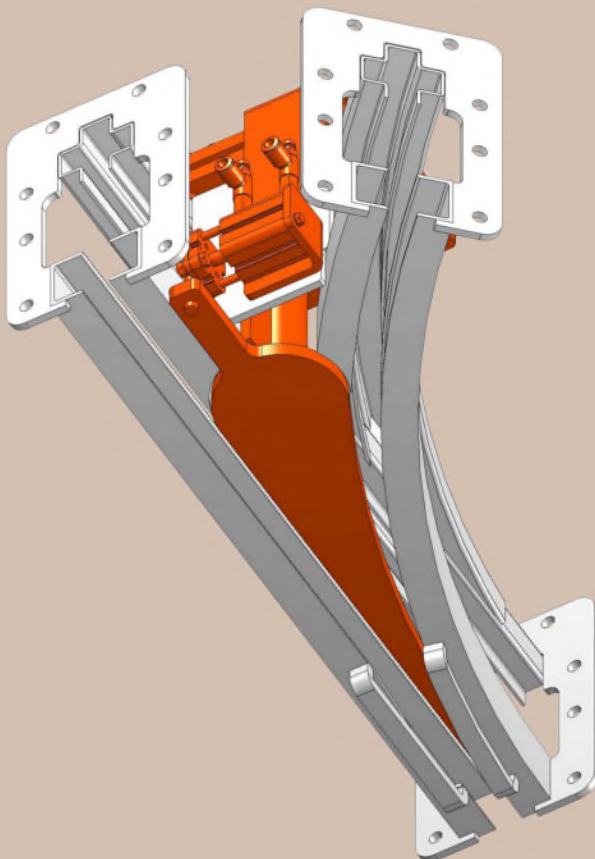

Mechanisch wechselnd /
mechanically changing

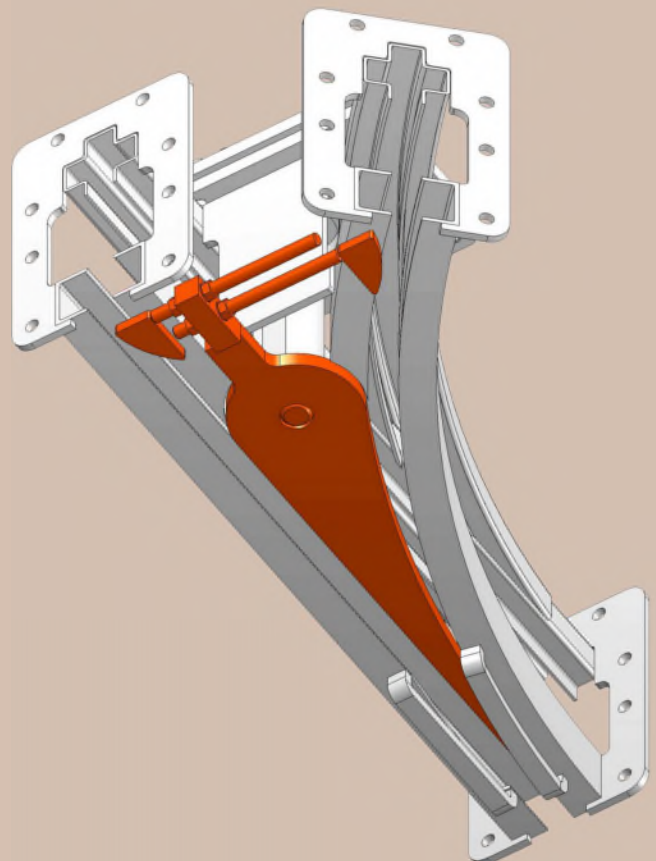

Weichen / track switches

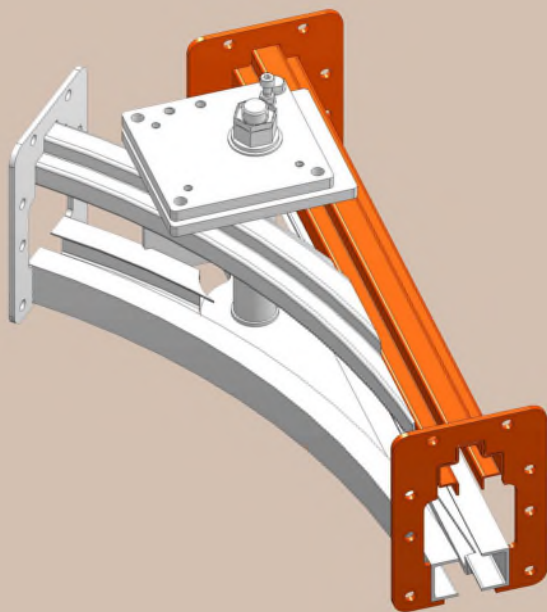

Kette in der Geraden / chain in straight track
(KIG)

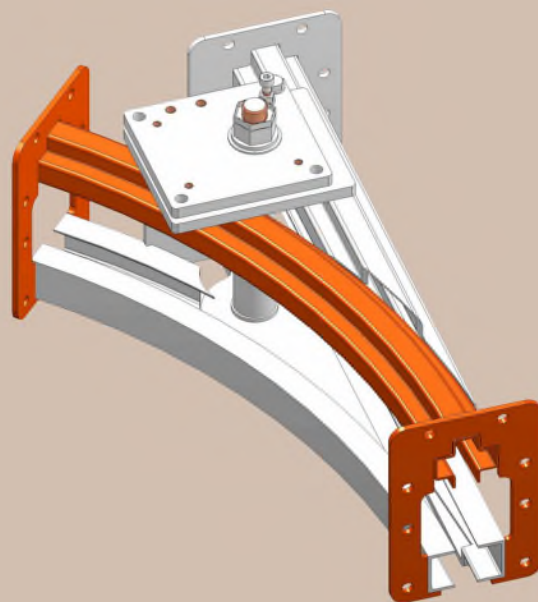

Kette im Bogen / chain in curve track
(KIB)

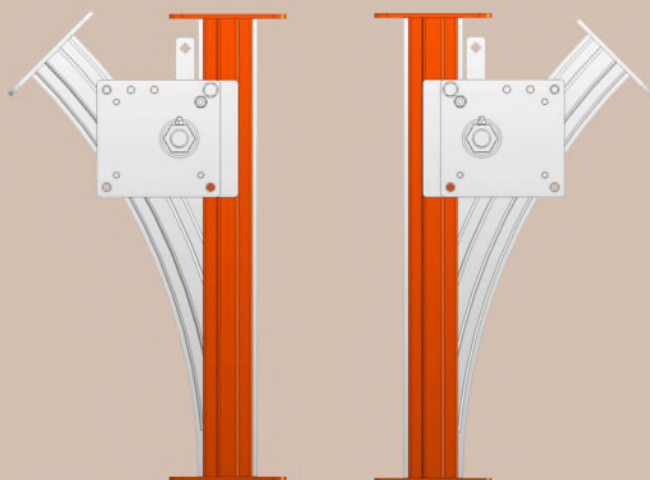

Links / left
(L)

Rechts / right
(R)

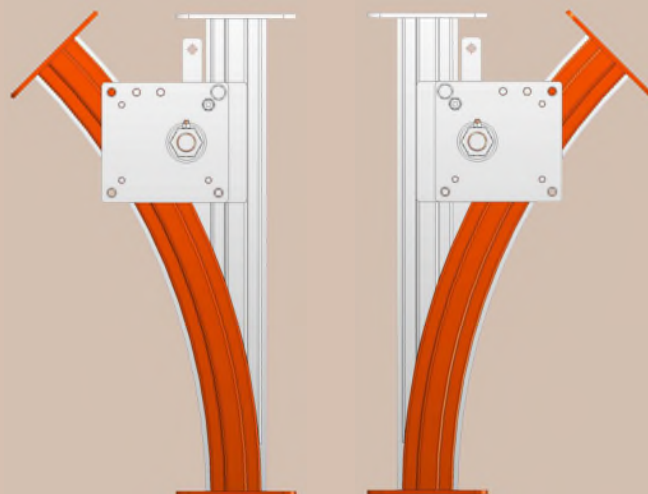

Links / left
(L)

Rechts / right
(R)

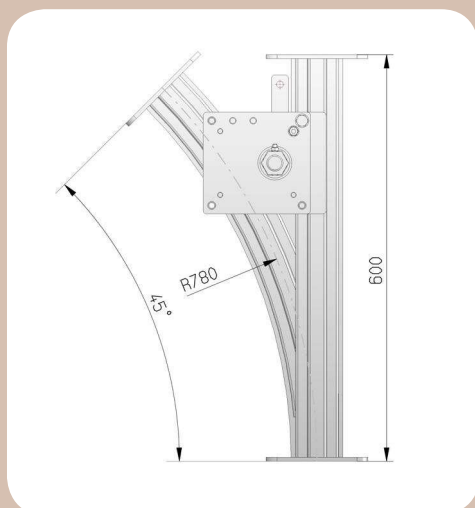

TFX 082-L311- ... (KIG / L)

TFX 082-L321- ... (KIG / R)

TFX 082-L312- ... (KIB / L)

TFX 082-L322- ... (KIB / R)

Steuerungstyp / controll type	TFX Code
Nicht gesteuert / none-controlled	... -101
Pneum. gesteuert / pneum. controlled	... -201
Mech. wechselnd / mech. changing	... -301

Weichen / track switches

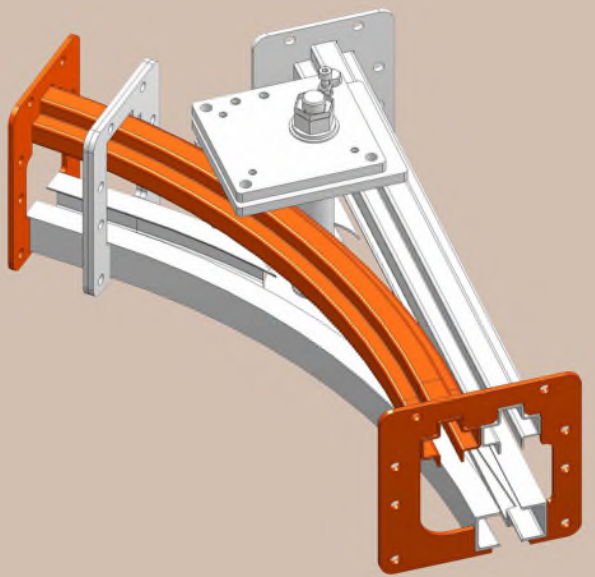

Kette in der Geraden, Einschub im Bogen /
chain in straight track, insertion in curve track
(KIG - EIB)

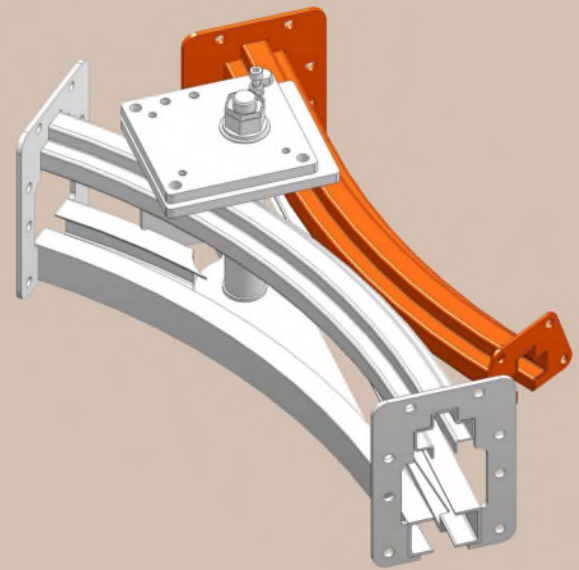

Kette im Bogen, Einschub in der Geraden
chain in curve track, insertion in straight track
(KIB - EIG)

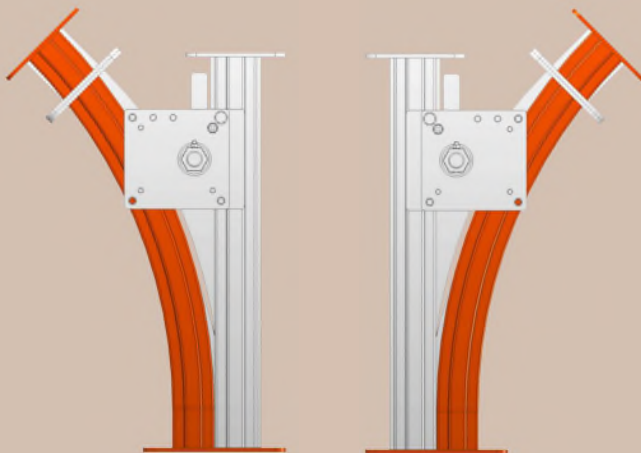

Links / left
(L)

Rechts / right
(R)

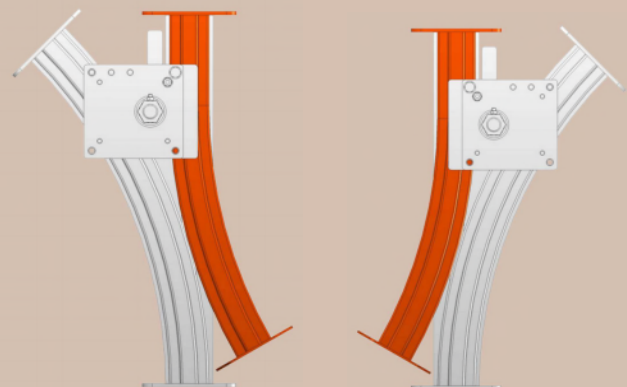

Links / left
(L)

Rechts / right
(R)

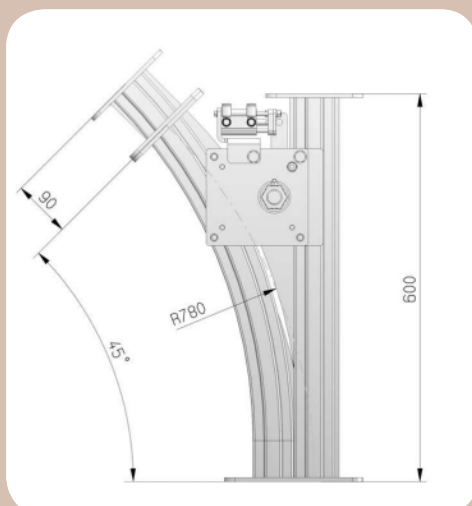

TFX 082-L313- ... (KIG - EIB / L)

TFX 082-L323- ... (KIG - EIB / R)

TFX 082-L314- ... (KIB - EIG / L)

TFX 082-L324- ... (KIB EIG/ R)

Steuerungstyp / controll type	TFX Code
Nicht gesteuert / none-controlled	... -101
Pneum. gesteuert / pneum. controlled	... -201
Mech. wechselnd / mech. changing	... -301

Anbau an Weichen / extension for track switches (KIG - EIB)

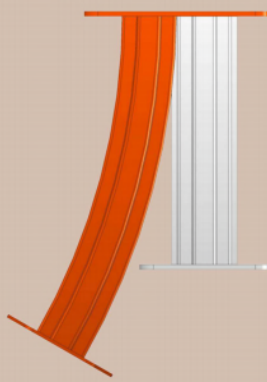
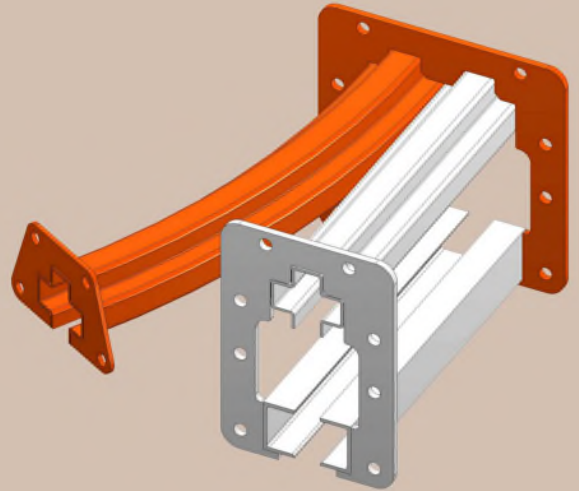
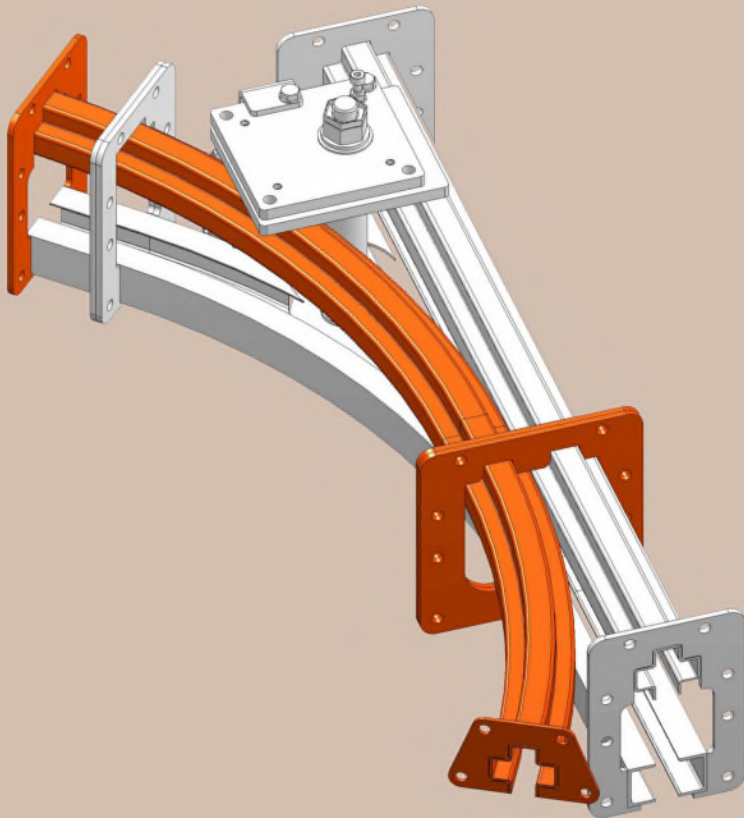

Links / left
(L)

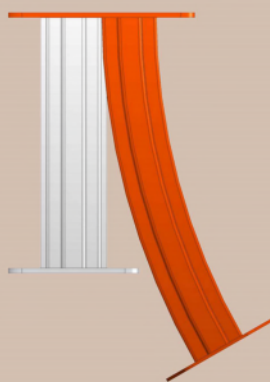

Rechts / right
(R)

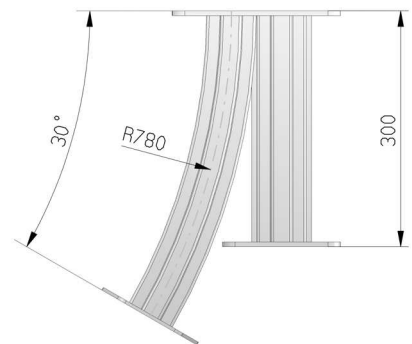

TFX 082-L315-001 (L)
TFX 082-L325-001 (R)

Mitnehmer / pusher dog

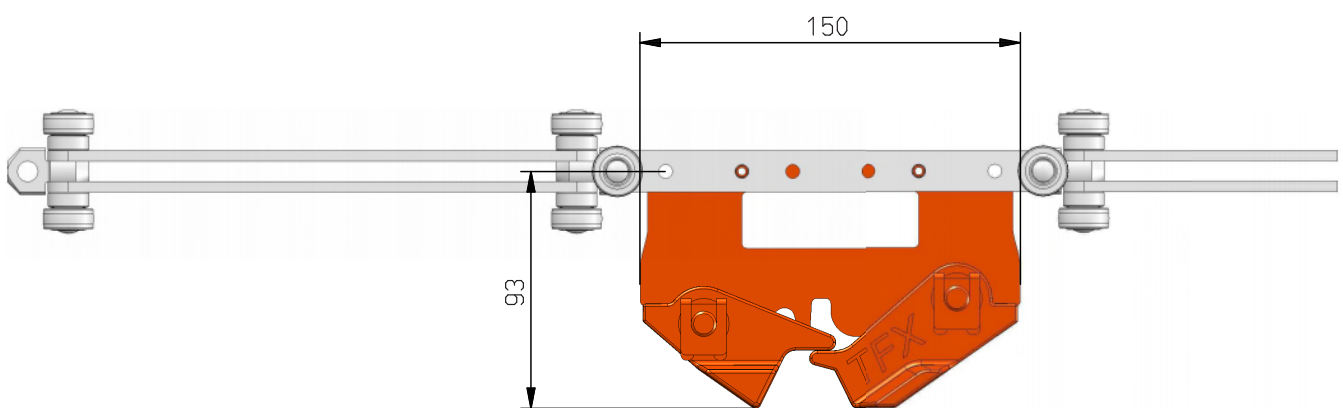
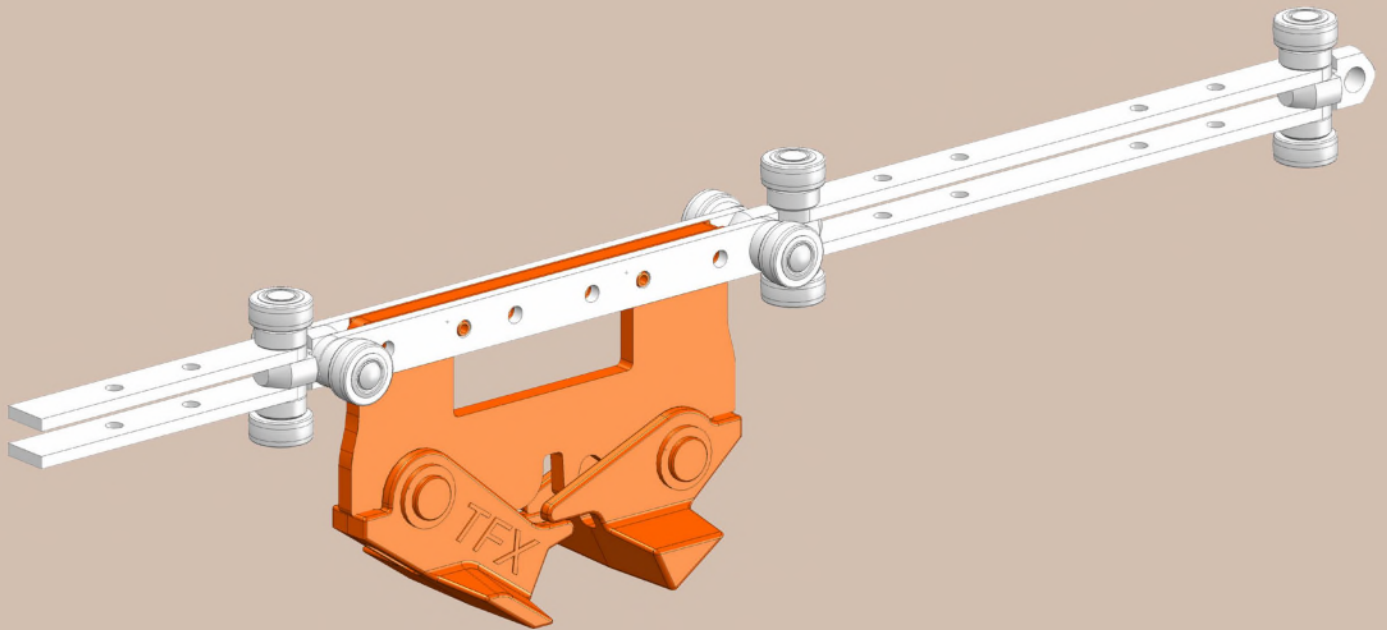

TFX 082-T111-001

Schleppketten-Antrieb / caterpillar drive unit

Antrieb mit Rutsch-Kupplung und
Getriebe-Motor /

Drive unit with friction clutch and
electric motor

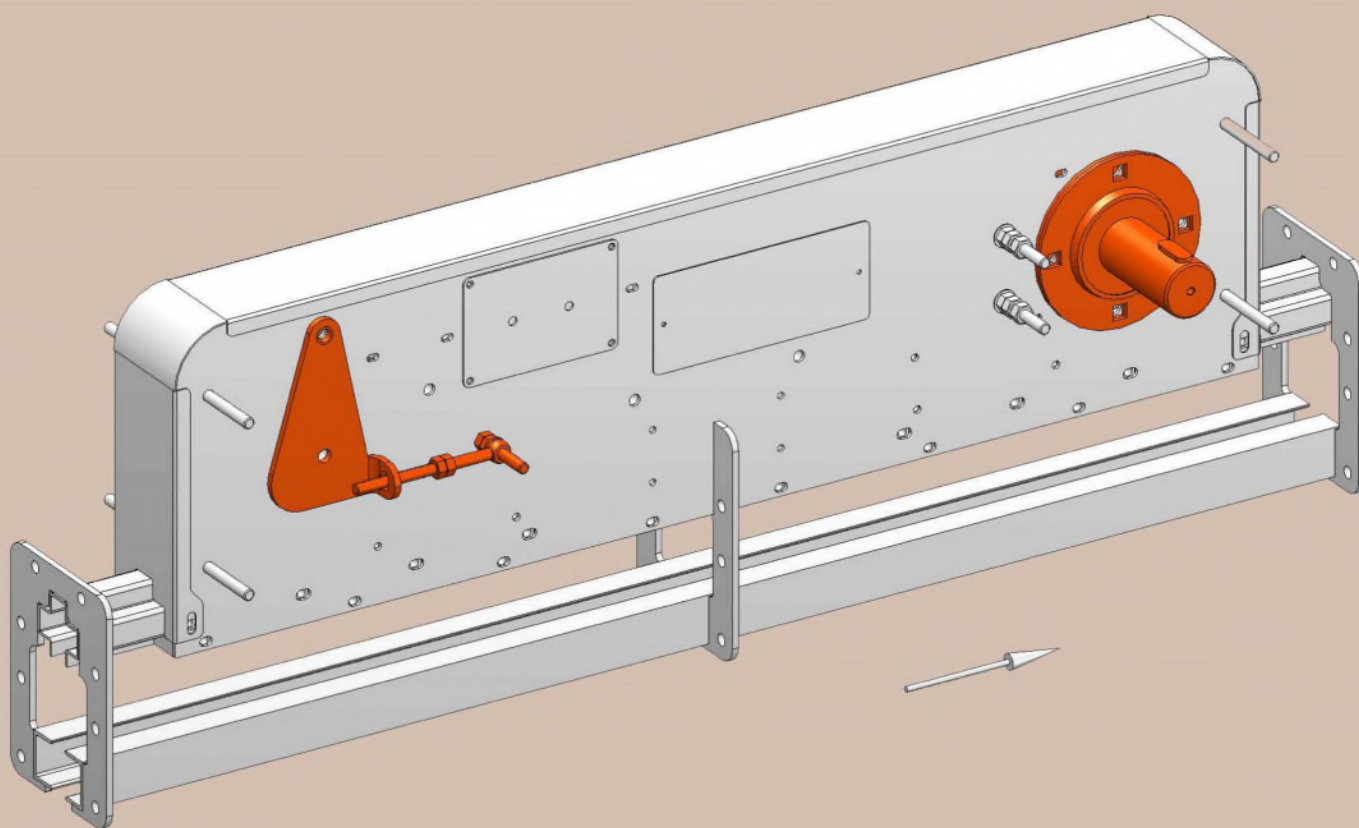
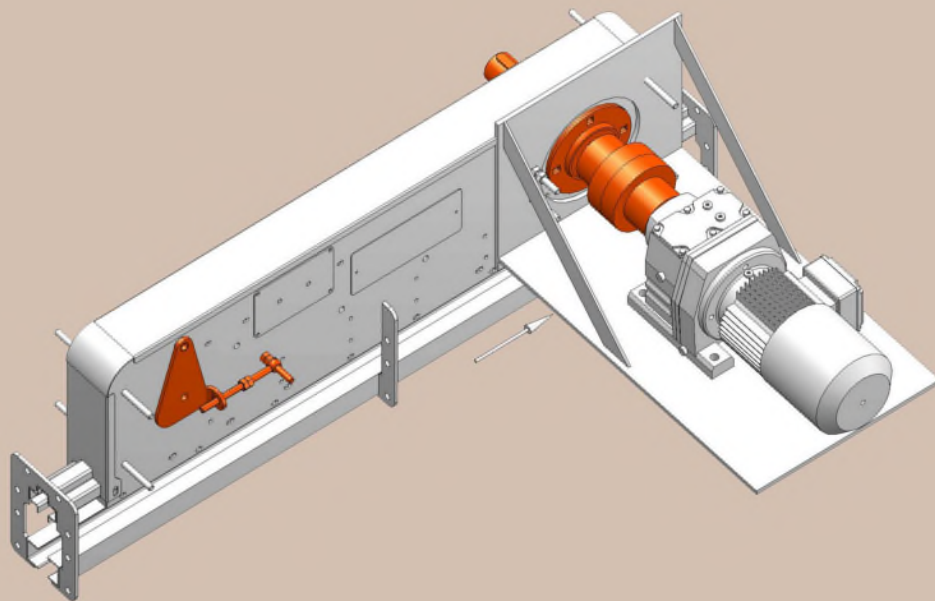

Fördergut-Gewicht / conveyed products weight

pro m Förderkette / per m conveyor chain max. 100 kg / 1000 N
pro Schleppketten-Antrieb / per drive unit max. 12000 kg / 120 kN

TFX 082-A110-001 (T = 200 mm)

Einbau-Länge / installation length (L)

Standard 1225 mm

Kontroll-Montage-Schiene / control assembly rail

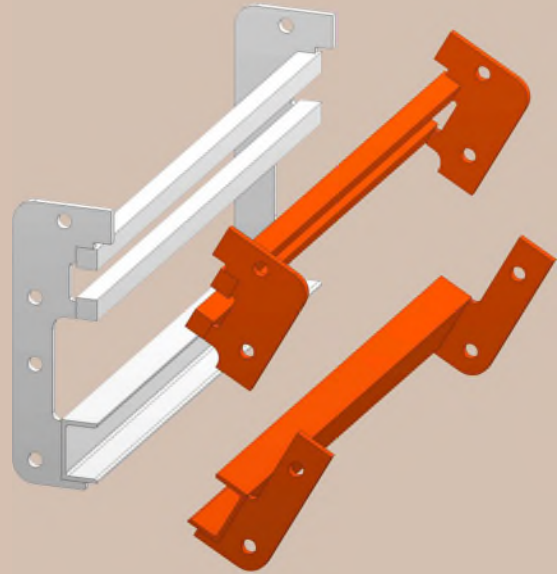
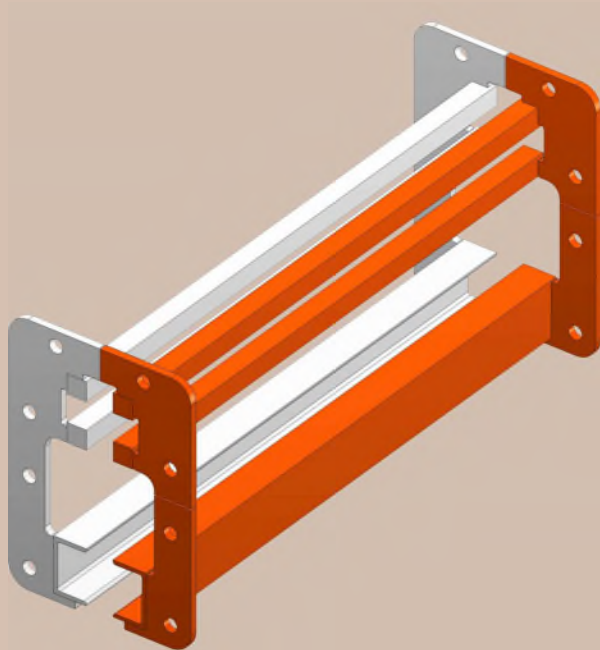

TFX 082-F110-001

Einbau-Länge / installation length (L)
Standard 450 mm

Spann-Station (Längenausgleich) / tension unit (length adjustment)

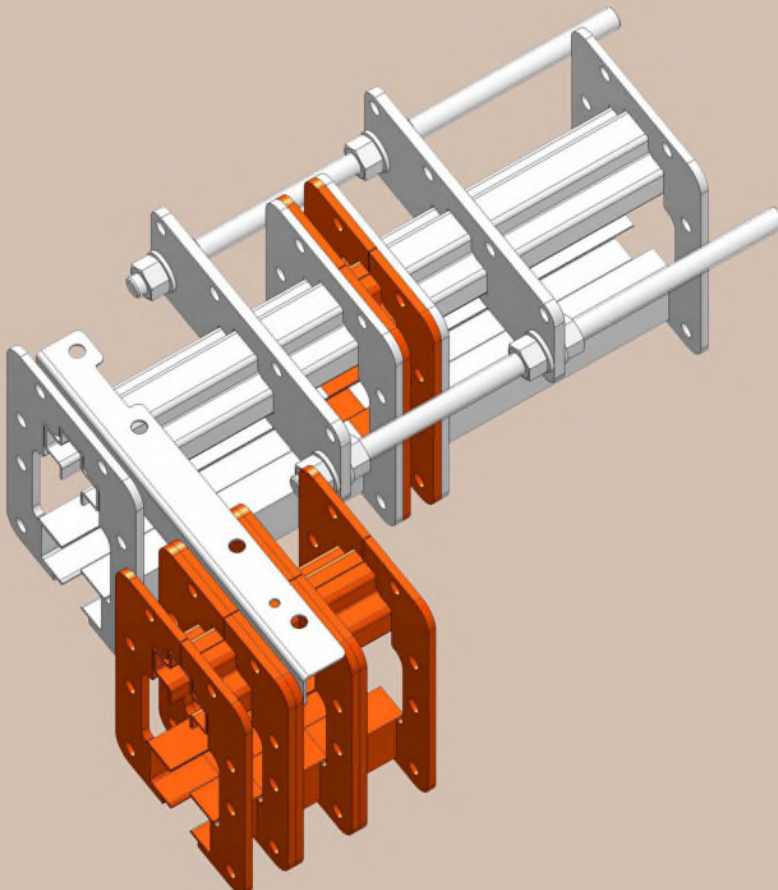

TFX 082-F211-001

Einbau-Länge / installation length (L)
Standard 450 mm
min. 420 mm (- 30 mm)
max. 600 mm (+ 40, 50, 60 mm)

Schmier-Station / lubrication unit

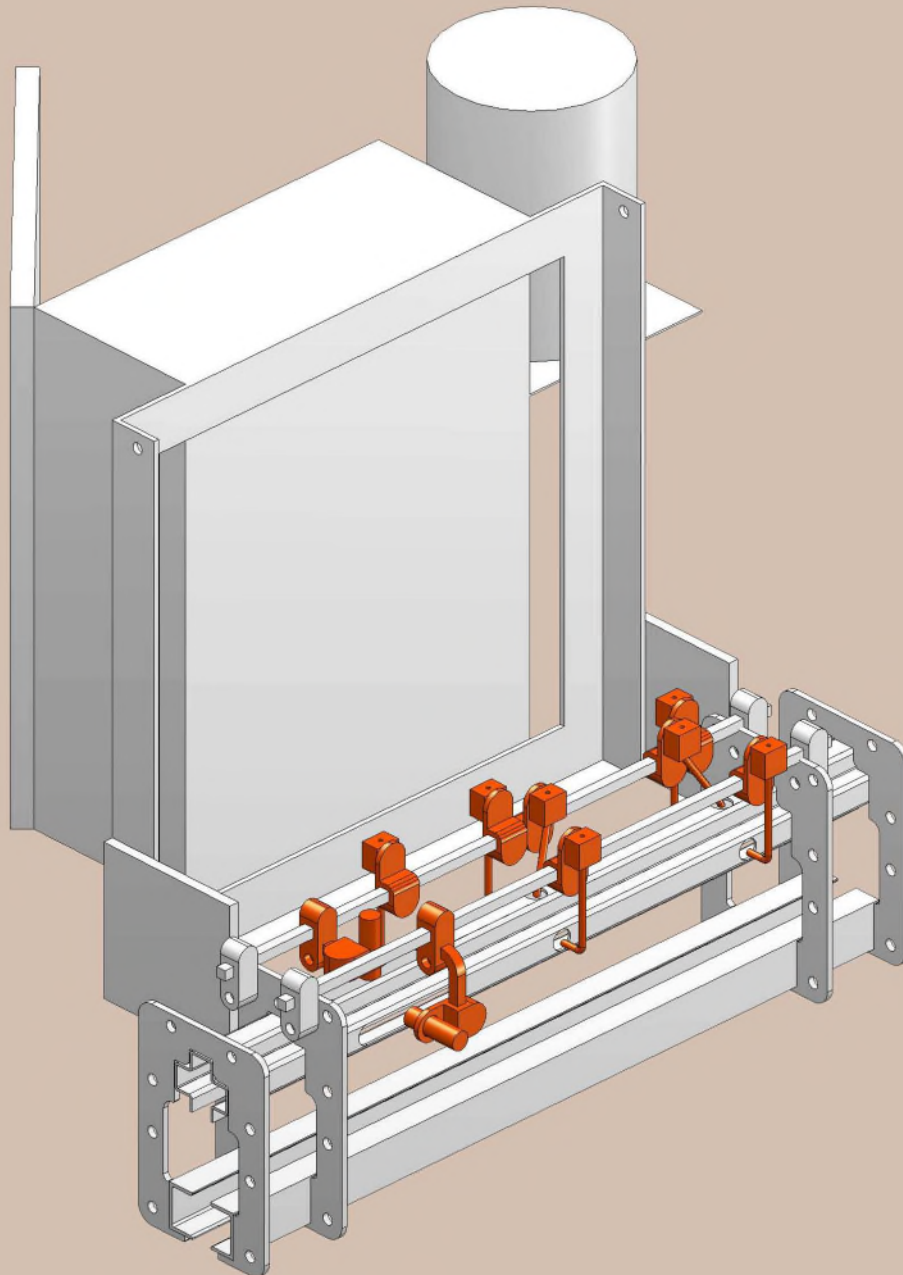
**TFX 081-F310-001 (T= 200 mm)**

Einbau-Länge / installation length (L)

Standard 750 mm

Stopp-Station / stop station

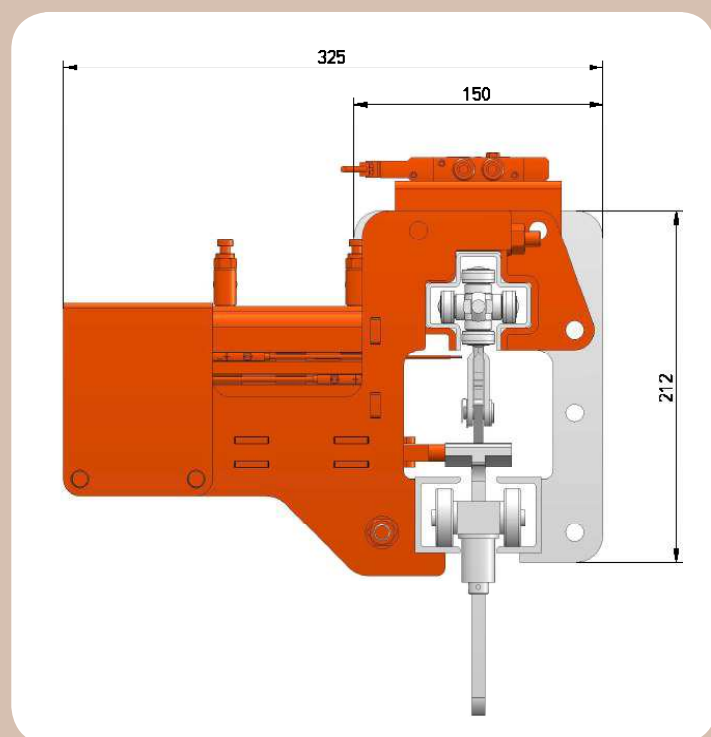
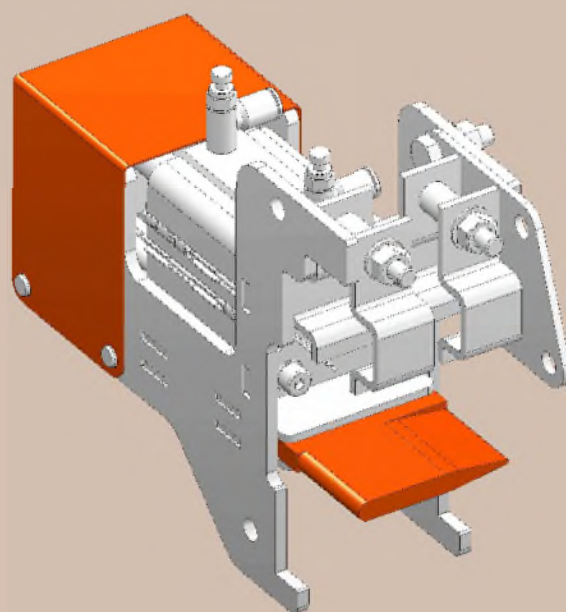
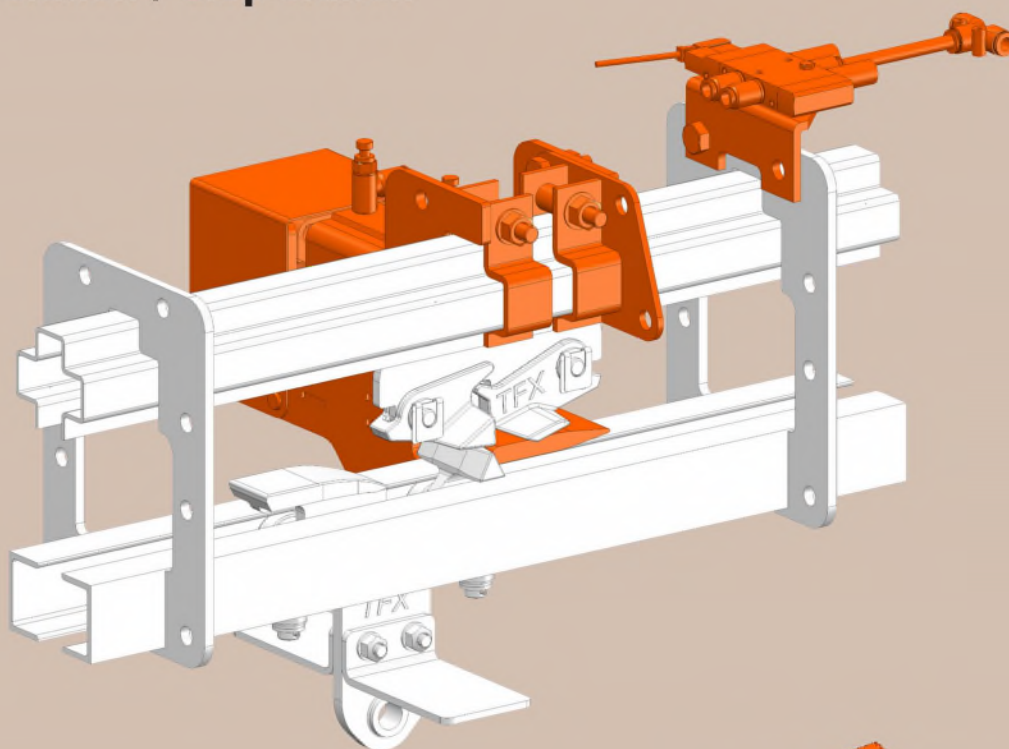

TFX 082-F410-001

Einbau-Länge / installation length (L)

Standard 100 mm

Rücklaufsperrern / runback stoppers

Leichte Ausführung / light type

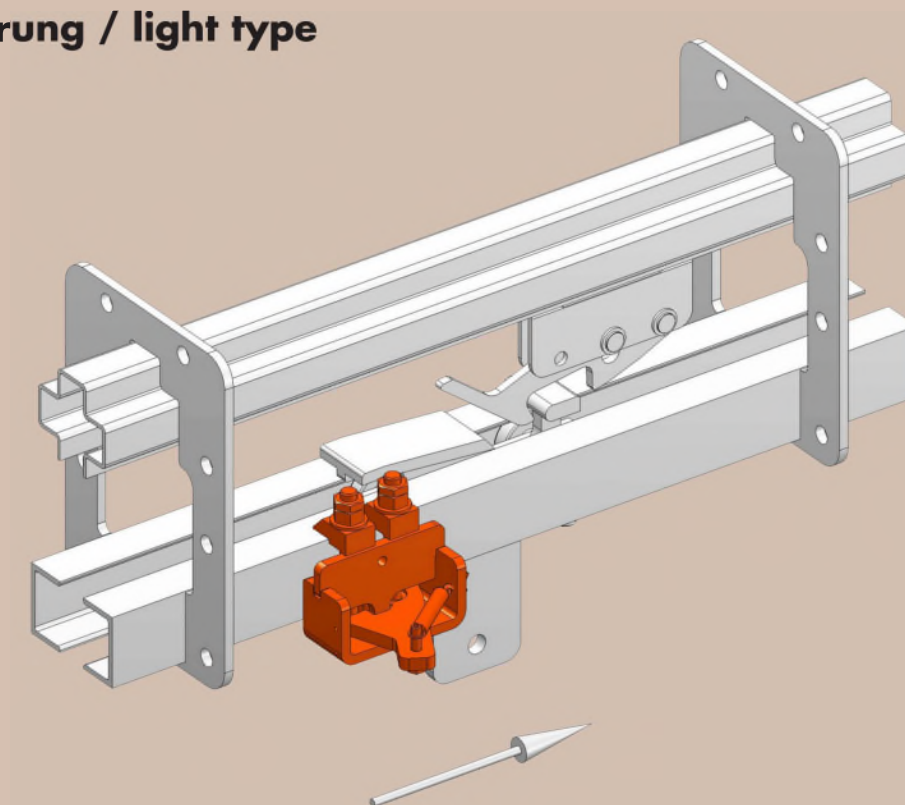

Sperrklinke aus Kunststoff zur Lärmvermeidung /
blocker element from plastic for noise prevention

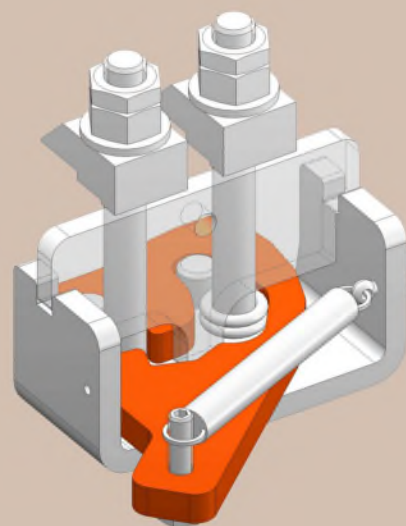
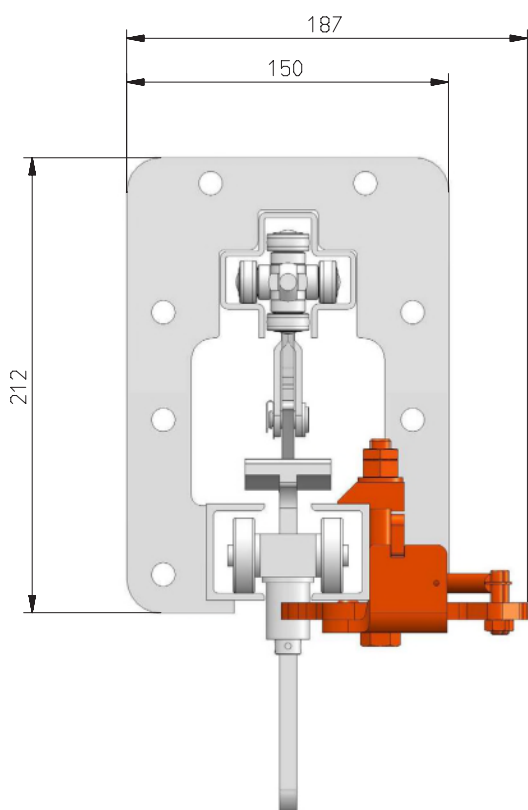

TFX 082-F511-001 (Kunststoff / plastic)

TFX 082-F512-001 (Stahl / steel)

Einbau-Länge / installation length (L)
--

Standard 90 mm

Rücklaufsperrern / runback stoppers

Schwere Ausführung / strong type

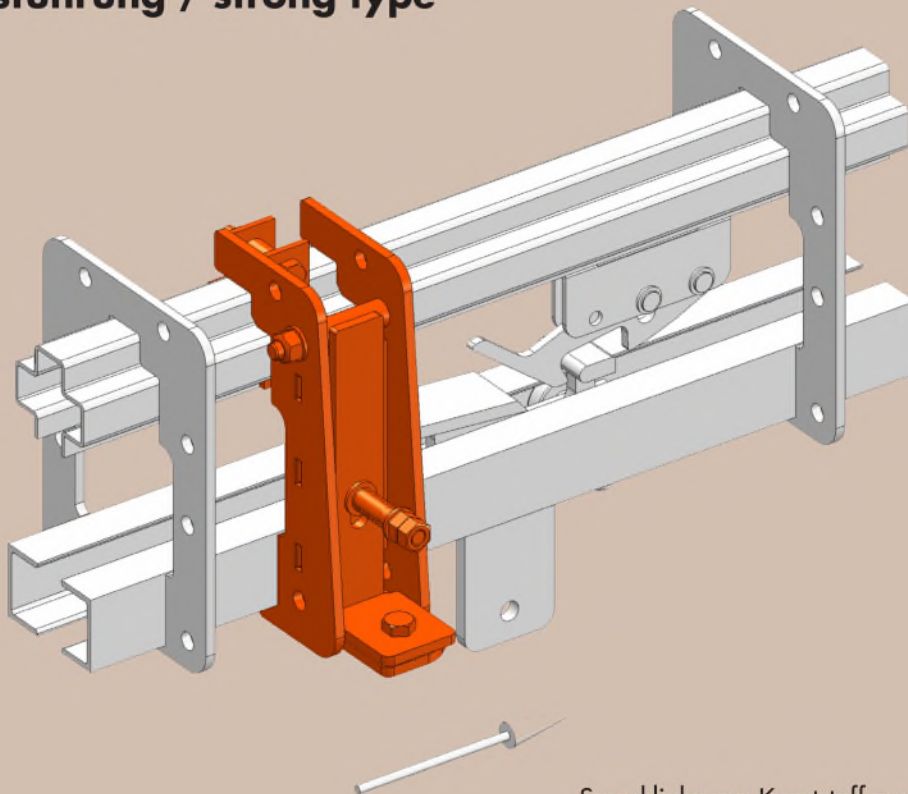

Sperrklinke aus Kunststoff zur Lärmvermeidung /
blocker element from plastic for noise prevention

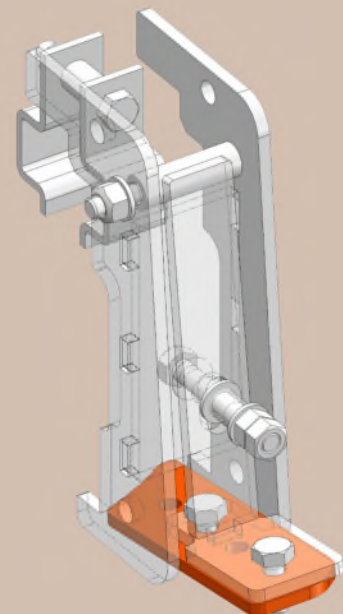
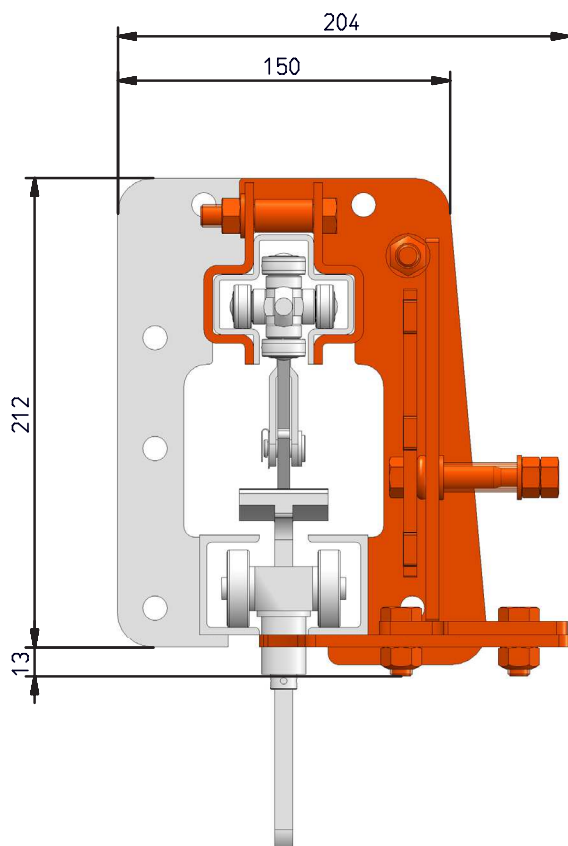

TFX 082-F513-001 (Kunststoff / plastic)

TFX 082-F514-001 (Stahl / steel)

Einbau-Länge / installation length (L)
--

Standard 90 mm

Transportwagen / trolleys

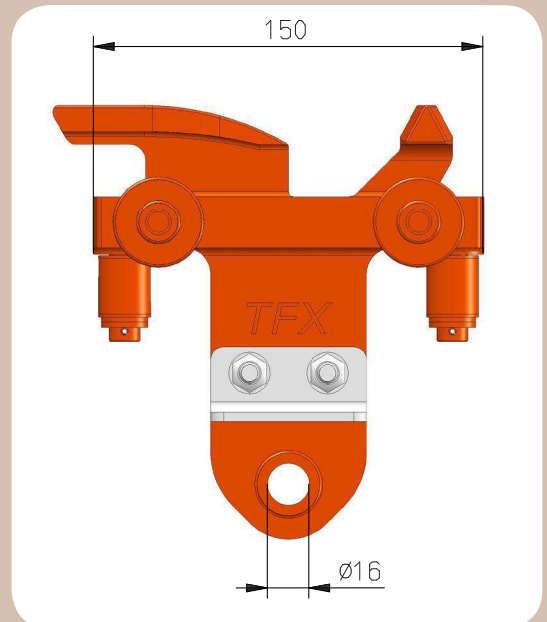
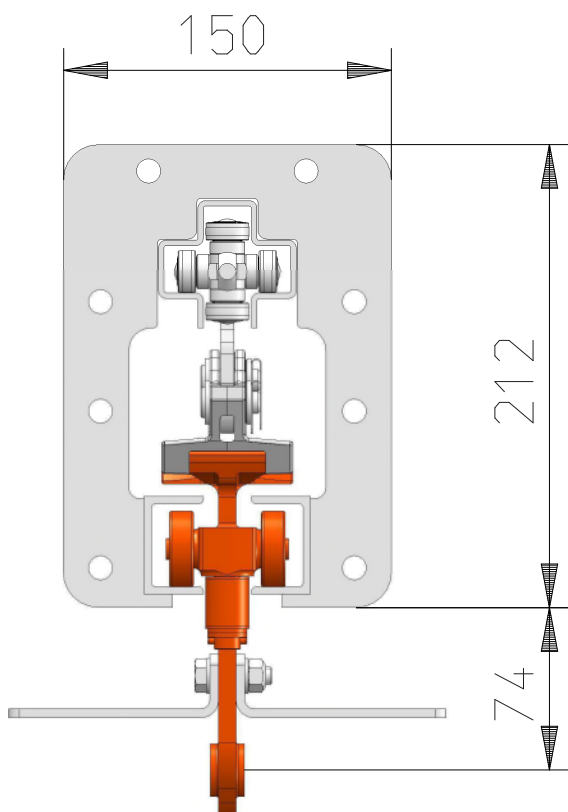
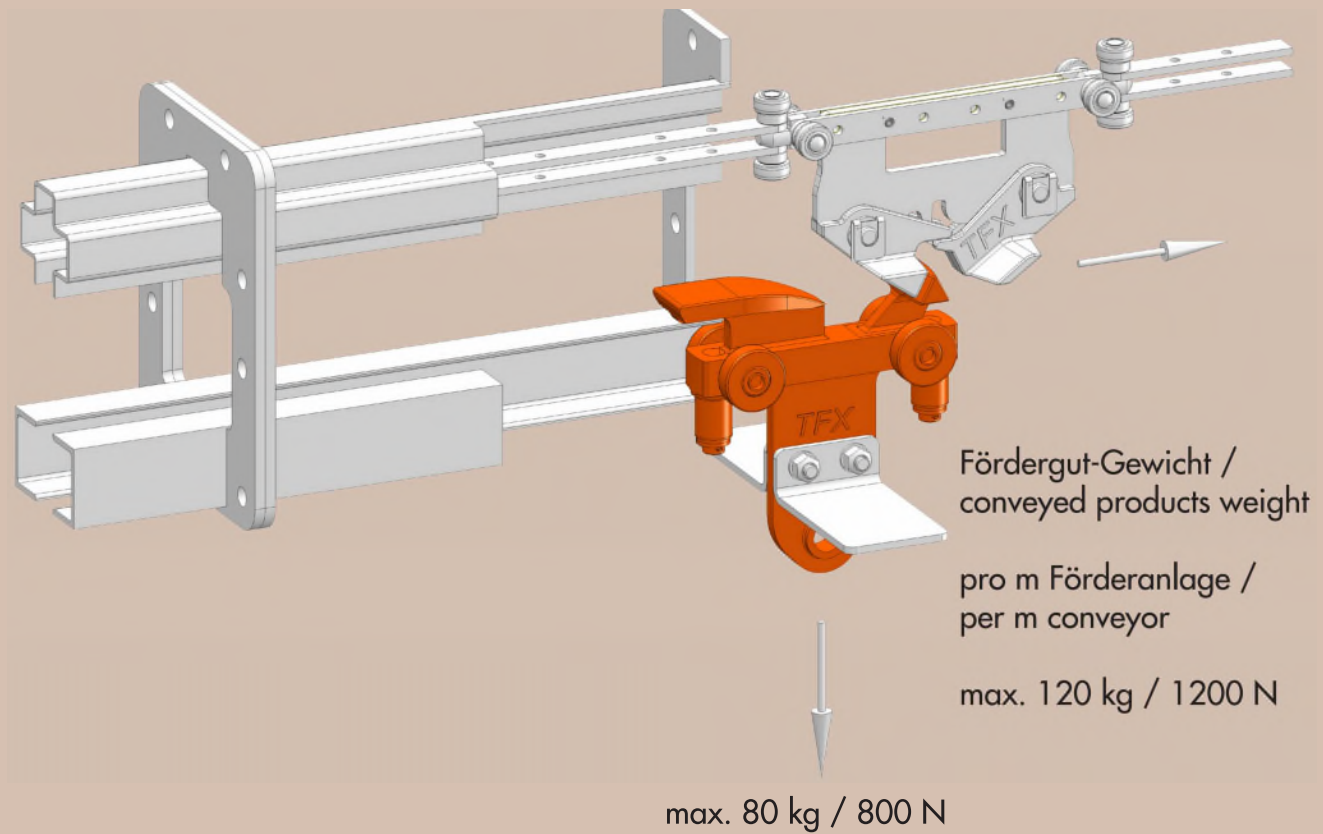

TFX 082-T211-001 (T max 120°C)

TFX 082-T212-001 (T max 240°C)

Stapel-Länge / buffer length (L)

Standard 150 mm

Traverse / loadbar

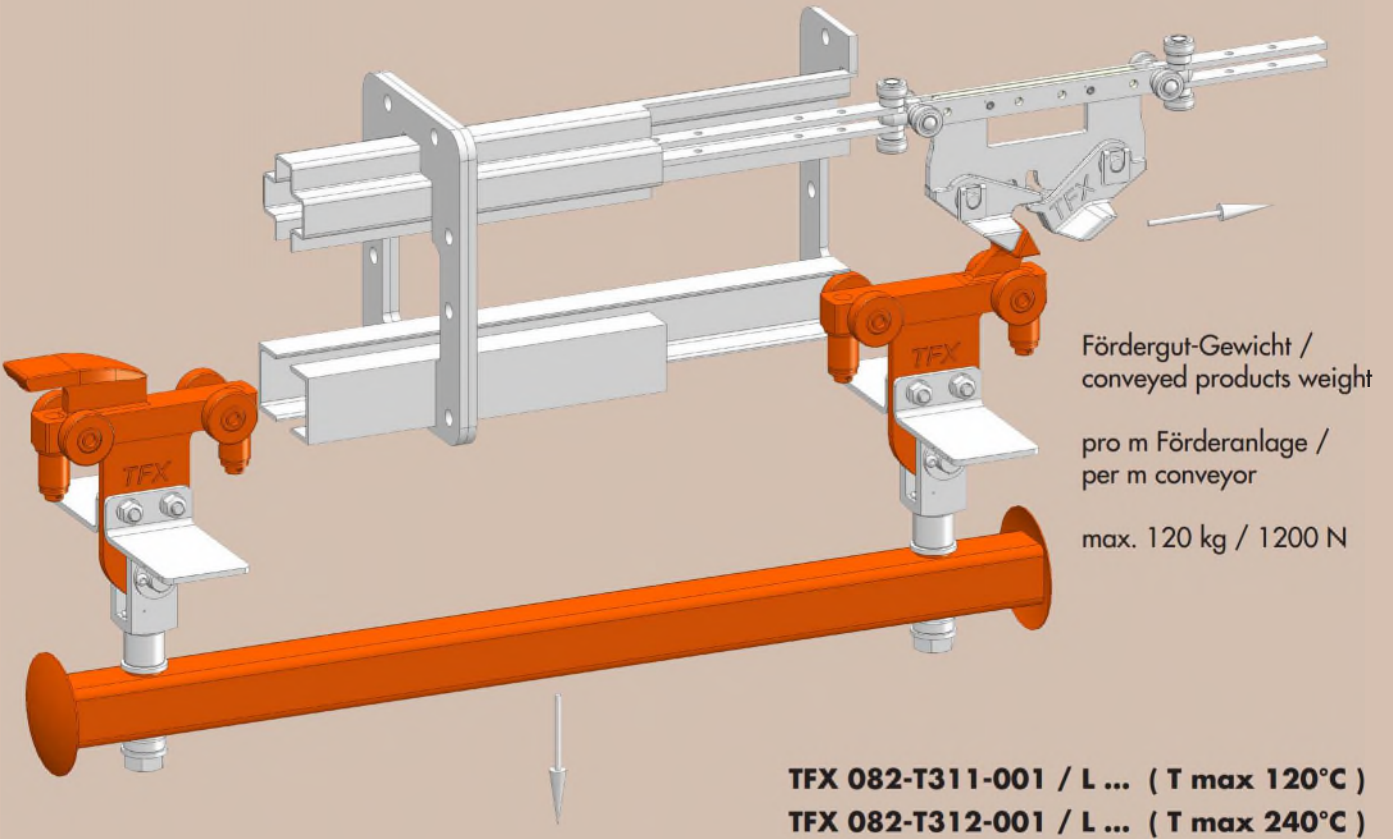

Stapel-Länge / buffer length (L)	TFX Code
Standard 1200 mm	... / L1200
350 bis / to 1190 mm	... / L ...

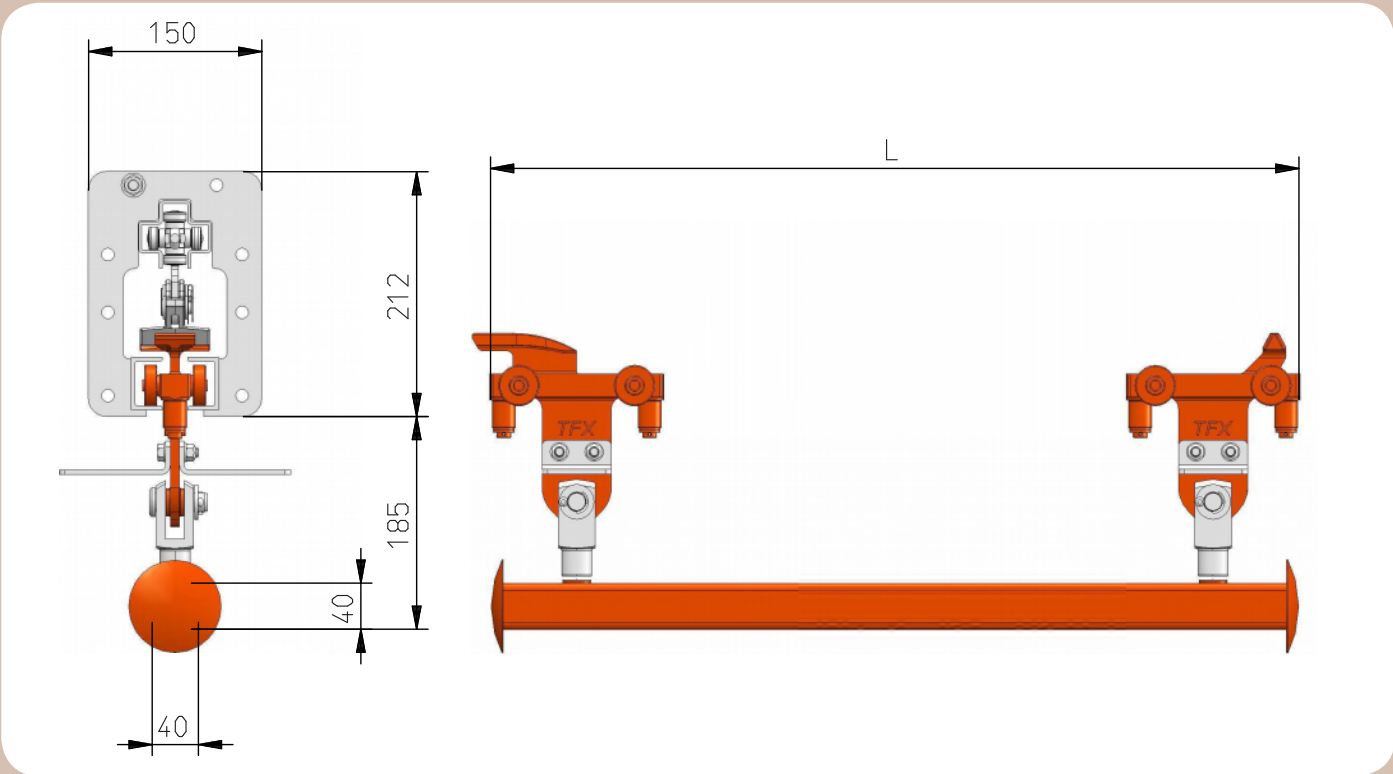

Einschub / pusher

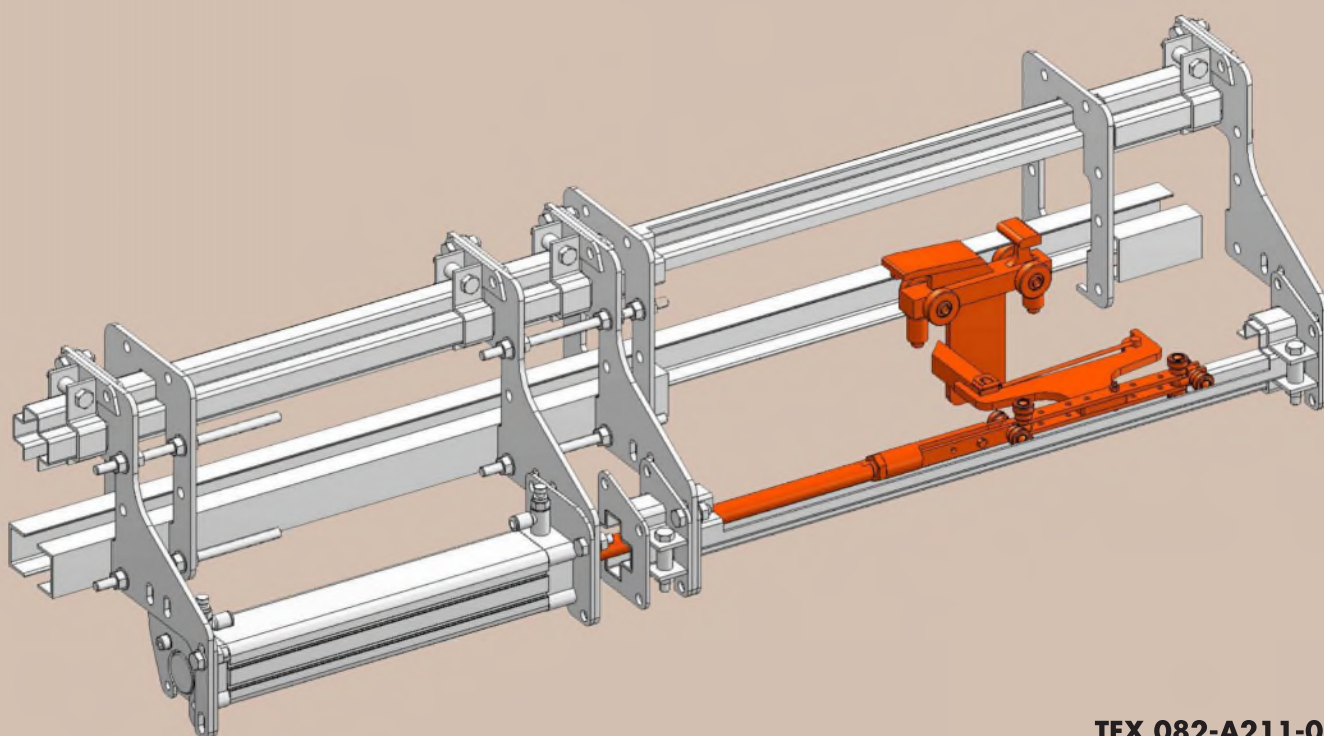
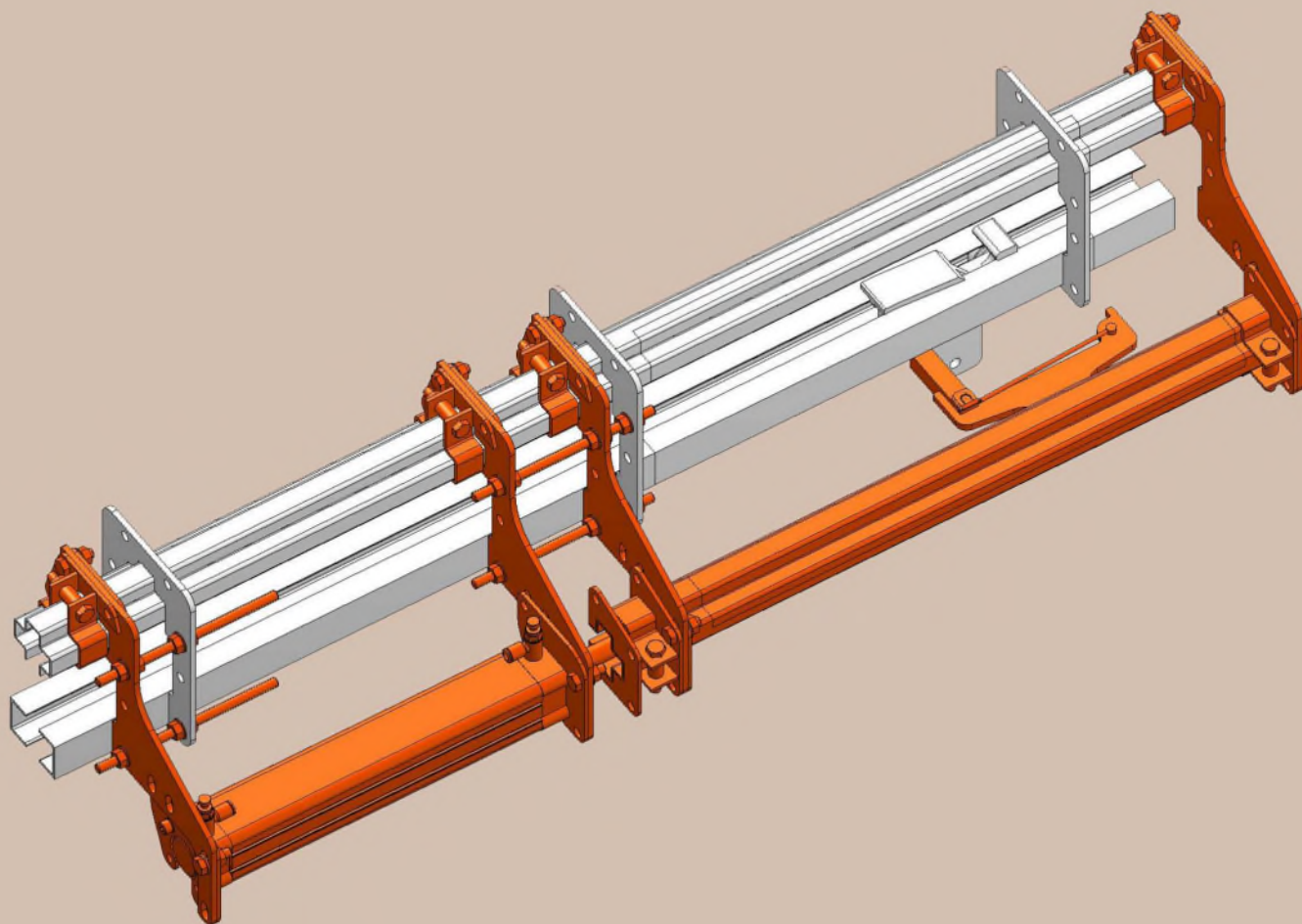

TFX 082-A211-001

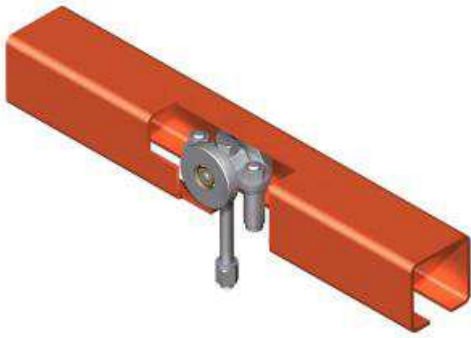

Handhängebahn / Monorail Conveyors

R30 Serie - bis 500 kg Stücklast / R30 series - up to 500 kg unit load

R40 Serie - bis 1500 kg Stücklast / R30 series - up to 1500 kg

R50 Serie - bis 3500 kg Stücklast / R30 series - up to 3500 kg

R60 Serie - bis 5000 kg Stücklast / R30 series - up to 5000 kg

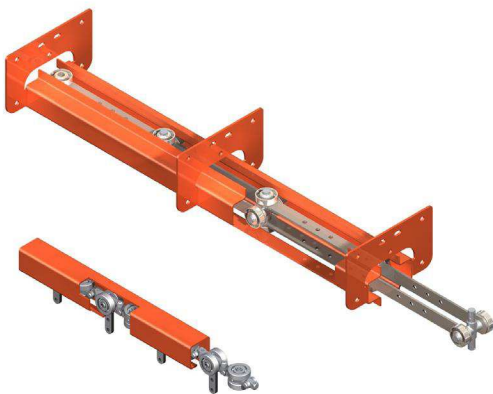

Kettenförderer / Overhead conveyors

STS - bis 100 kg Stücklast / STS - up to 100 kg unit load

D8 - bis 300 kg Stücklast / D8 - up to 300 kg unit load

Optionen / options:

- Inventiert / inverted
- Bauseitig montiert / side mounted
- Boden montiert / floor mounted

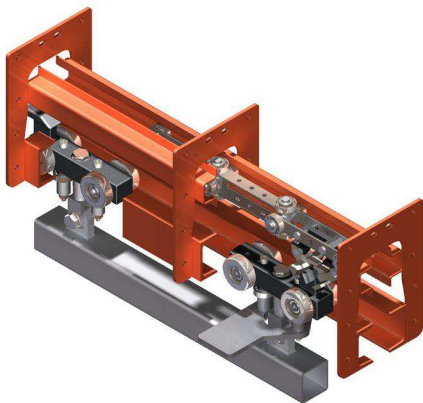

Power & Free Förderer / Conveyors

T1 - bis 500 kg Stücklast / T1 - up to 500 kg unit load

T4 - bis 2000 kg Stücklast / T4 - up to 2000 kg unit load

T5 - bis 5000 kg Stücklast / T5 - up to 5000 kg unit load

Decken- und Bodenmontage ist möglich

Overhead & floor mounted orientations are available

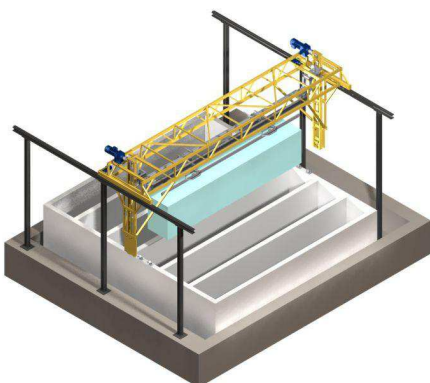

Crane Systems

Tauch Becken Brücke / Dipping Tank Crane

Verschiebe Brücke / Bridge Crane

Erhältlich als Stand-Alone-Produkte oder als Teil eines voll integrierten automatischen Hängebahn-System

Available as stand alone items or as part of a fully integrated automatic overhead conveyor system

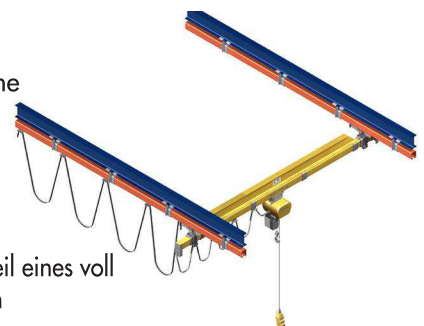



TFX Railtechnik GmbH (DE)



Railtechniek
van Herwijnen BV (NL)



Teleflex BV (NL)
Dunnewolt BV (NL)



Railtechnique SARL (FR)



Stewart Gill Conveyors Ltd (UK)

"Wer ist die TFX RAILTECHNIK GmbH?"

Die TFX RAILTECHNIK GmbH ist spezialisiert auf die Planung, Produktion, Installation und Wartung von Kreisförder- und Power&Free-Förderanlagen, sowie Handhängebahnen. Seit über 50 Jahren werden unsere Förderanlagen in allen Bereichen der Industrie erfolgreich eingesetzt.

Vormals bekannt als TELEFLEX GmbH, wurde die TFX RAILTECHNIK GmbH im Jahr 2002 Teil der Unternehmensgruppe Railtechnik van Herwijnen B.V. in den Niederlanden. Dadurch können wir inzwischen eine breite Palette an Förderanlagen zum Transport von Produkten bis zu einem Einzelgewicht von 5000 kg anbieten.

Unsere Produktpalette reicht von manuellen bis hin zu vollständig automatisierten Systemen, welche volle Produktverfolgung und wechselseitigen Datenaustausch mit kundenseitigen E-Steuerungen (SPS) ermöglicht. Wir entwickeln individuelle Fördergutaufnahmen für die zu transportierenden Produkte bis hin zu Boden- oder Deckenstahlbau zur Aufhängung der Förderanlage.

Neben den Planungs- und Produktionsmöglichkeiten in unserem eigenen Werk in Heiligenhaus, kann die TFX RAILTECHNIK GmbH auch auf die Ressourcen der Unternehmensgruppe in den Niederlanden, Großbritannien und Moldavien zurück greifen.

Mit der gemeinsamen Erfahrung der gesamten Unternehmensgruppe können wir für die meisten Anforderungen an den industriellen Materialtransport passende Lösungen anbieten.

Die TFX RAILTECHNIK GmbH liefert Förderanlagen an Kunden weltweit.

Kontakt / Contact

Planung und Produktion / engineering and production

Unternehmens-Gruppe / corporate group

TFX RAILTECHNIK GmbH

Weilenburgstrasse 20
42579 Heiligenhaus
Deutschland / Germany

Fon +49 - 2056 - 2665-0
Fax +49 - 2056 - 2665-90
E-Mail info@tfx-railtechnik.de
Internet www.tfx-railtechnik.de

RAILTECHNIEK VAN HERWIJNEN B.V.

Koelenhofstraat 13
4004 HE Tiel
Niederlande / Netherlands

Fon +31 - 344 - 61 63 63
Fax +31 - 344 - 61 10 72
E-Mail info@railtechniek.nl
Internet www.railtechniek.nl

Geschäftsführer / managing directors
M.R.A. van Herwijnen / J.G.E. van Herwijnen

Amtsgericht Wuppertal HRB 18634
USt.-IdNr.: DE 813198739

Vertrieb / sales manager
Wolfgang Neiß
Reifenberger Weg 6
61479 Glashütten
Deutschland / Germany

Fon +49 - 6082 - 9109-28
Fax +49 - 6082 - 9109-29
Mobil +49 - 171 - 875 03 05
E-Mail wolfgang.neiss@tfx-railtechnik.de



Railtechniek van Herwijnen Group:

RAILTECHNIEK VAN HERWIJNEN BV
RAILTECHNIQUE FRANCE SARL
TFX-RAILTECHNIK GmbH
RAILTECHNIQUE SRL MOLDOVA
STEWART GILL CONVEYORS LTD
TELEFLEX BV
DUNNEWOLT BV

